

Adams LubeTech Limited

- *Lubricator&Oiler*
- *Constant&Level Oilers*
- *Oil Level&Windows*
- *Drip Feed Lubricators*

Adams Lube Tech Limited

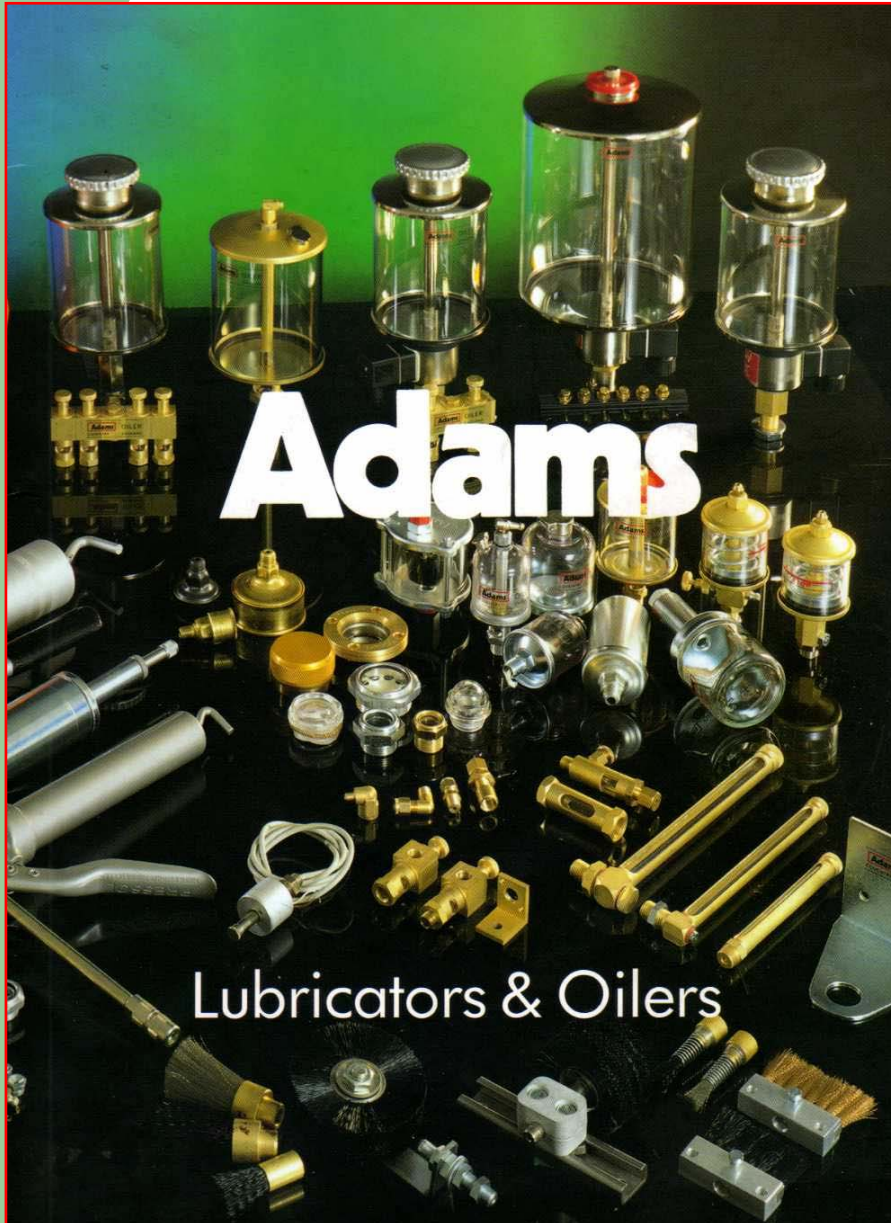

Adams

Lubricators & Oilers



The Company was founded by George Adams in 1942, who recognised a supply shortage in the local machine tool industry. In 1999 the Company became known as Adams LubeTech Limited and also moved to its present site in the same year.

Today Adams LubeTech has an unrivalled reputation as a manufacturer of single point 'Oilers and Lubricators', exporting to many countries throughout the world.

A comprehensive range of 'Centralized Systems' for machine tool lubrication is also available and a catalogue can be obtained on request.

The Company is registered to quality management system BS EN ISO 9002.

Contents

Drip Feed Lubricators
3 - 18

Spring Greasers and Cups
19 - 22

Constant Level Oilers
23 - 26

Oil Levels and Windows
27 - 32

Oil Hole Covers and Cups
33 - 36

Grease Nipples
37 - 40

Fittings and Accessories
41 - 44

Grease Guns, Oil Cans
And Funnels
45 - 48

As part of its development process the company reserves the right to modify any product or specification without prior notice.

All sizes, weights and measures are approximate.



L'entreprise a été fondée en 1942 par George Adams, qui avait remarqué une pénurie de matériel de lubrification au sein de l'industrie locale de la machine-outil. En 1999 la compagnie est devenue notoire comme Adams LubeTech Limité et également déplacé à son site par même année.

Adams LubeTech, qui jouit aujourd'hui d'une réputation sans égale dans la fabrication des 'Lubrificateurs et huileurs' monopoints, exporte dans de nombreux pays de monde.

Il propose également une gamme complète de 'Systèmes centralisés' pour la lubrification des machine-outils. Un catalogue est disponible sur demande.

La société est homologuée selon le système de gestion de la qualité BS EN ISO 9002.

Sommaire

Lubrificateurs Goutte à Goutte
3 - 18

Graisseurs Automatiques et
Graisseurs à Réserve
19 - 22

Huiliers à Niveau Constant
23 - 26

Niveaux d'Huile et Voyants
27 - 32

Bouchons et Coupelles
33 - 36

Graisseurs
37 - 40

Barrettes de Graissage et
Accessoires
41 - 44

Pistolets à Graisse, Burettes
et Entonnnoirs
45 - 48

Dans le cadre de son processus de développement, la société se réserve le droit de modifier sans préavis ses produits ou leurs caractéristiques.

Les dimensions, poids et mesures mentionnés n'ont qu'une valeur indicative.



Das Unternehmen wurde 1942 von George Adams gegründet. Er hatte erkannt, dass es in der Werkzeugmaschinenindustrie an geeigneten Schmiereinrichtungen mangelte. 1999 zog die Firma in moderne Räume um und firmiert seitdem als Adams LubeTech Ltd.

Heute genießt Adams LubeTech den Ruf eines Herstellers von Schmiereinrichtungen höchster Qualität für Öl und Fett, dessen Produkte in alle Welt exportiert werden.

Neben den in diesem Katalog gezeigten einfachen Schmiergeräten hat Adams ein umfangreiches Programm von Zentralschmieranlagen. Auf Wunsch senden wir Ihnen gerne den Spezialkatalog.

Die Qualitätssicherung des Unternehmens ist zertifiziert nach BS EN ISO 9002.

Inhalt

Tropföler
3 - 18

Schmierbüchsen und
Staufferbüchsen
19 - 22

Ölstandsregler
(Constant Level Oler)
23 - 26

Ölstandsanzeiger und Ölaugen
27 - 32

Klappöler und Kugelöler
33 - 36

Schmiernippel
37 - 40

Schottverschraubungen und
Zubehör
41 - 44

Fettpressen, Ölkannen und
Trichter
45 - 48

Im Rahmen unserer Politik der ständigen Verbesserung behalten wir uns das Recht vor, unsere Produkte ohne vorherige Ankündigung zu ändern.

Alle Maße, Gewichte und Größenangaben sind Näherungswerte.

Drip Feed Lubricators

Adams



Drip Feed Lubricators

A range of gravity and forced feed oilers for lubricating single or multiple points and for use in conjunction with brushes to lubricate conveyor chains. Reservoirs are available in plexiglass or glass and range in capacity from 14 cc to 3 litres. Solenoid operation and timers are optional.

Lubrificateurs Goutte à Goutte

Une gamme de huileurs par gravité pour lubrifier un ou plusieurs points et en conjonction avec des brosses pour la lubrification des chaînes. Les réservoirs d'une capacité de 14 cm³ à 3 litres sont disponibles en plexiglass ou en verre. Ils peuvent être équipés d'une vanne électrique commandée par une minuterie.

Tropföler

Lieferbar sowohl als Schwerkraftsystem als auch als Drucksystem zur Schmierung einzelner oder mehrerer Stellen. Bürsten als Zubehör ermöglichen die Schmierung von Ketten. Vorratsbehälter von 14 ml bis 3l sind lieferbar in Plexiglas oder Glas. Magnetventile und Zeitsteuerungen ermöglichen volle Automatisierung.

Drip Feed Lubricators

MANUAL ON/OFF SINGLE OUTLET Material - BRASS Bottle - GLASS Maximum operating temperature 80°C

Product Code	A	B	C	D	E	Capacity ml
GSF 130	1/4 BSP	97	10	30	30	15
GSFN 130	1/4 NPT					
GSF 230	1/2 BSP					
GSFN 230	1/2 NPT					
GSF 240	1/2 BSP	110	12	36	40	35
GSFN 240	1/2 NPT					
GSF 340	3/4 BSP					
GSFN 340	3/4 NPT					
GSF 250	1/2 BSP	126	12	50	50	80
GSFN 250	1/2 NPT					
GSF 350	3/8 BSP					
GSFN 350	3/8 NPT					
GSF 260	1/2 BSP	140	12	60	60	150
GSFN 260	1/2 NPT					
GSF 360	3/8 BSP					
GSFN 360	3/8 NPT					
GSF 460	1/2 BSP	160	12	80	60	200
GSFN 460	1/2 NPT					
GSF 268	3/8 BSP					
GSFN 268	3/8 NPT					
GSF 368	3/8 BSP	185	16	100	80	400
GSFN 368	3/8 NPT					
GSF 468	1/2 BSP					
GSFN 468	1/2 NPT					
GSF 380	3/8 BSP	210	16	120	100	900
GSFN 380	3/8 NPT					
GSF 480	1/2 BSP					
GSFN 480	1/2 NPT					
GSF 4100	1/2 BSP	210	16	120	100	900
GSFN 4100	1/2 NPT					
GSF 5100	3/4 BSP					
GSFN 5100	3/4 NPT					

Seals - FIBRE & NITRILE 80
Finish - NATURAL BRASS



Material - BRASS Bottle - PLEXIGLASS Maximum operating temperature 70°C

Product Code	A	B	C	D	E	Capacity ml
PSF 130	1/4 BSP	97	10	30	30	15
PSFN 130	1/4 NPT					
PSF 230	1/2 BSP					
PSFN 230	1/2 NPT					
PSF 240	1/2 BSP	110	12	36	40	35
PSFN 240	1/2 NPT					
PSF 340	3/8 BSP					
PSFN 340	3/8 NPT					
PSF 250	1/2 BSP	126	12	50	50	80
PSFN 250	1/2 NPT					
PSF 350	3/8 BSP					
PSFN 350	3/8 NPT					
PSF 260	1/2 BSP	140	12	60	60	150
PSFN 260	1/2 NPT					
PSF 360	3/8 BSP					
PSFN 360	3/8 NPT					
PSF 460	1/2 BSP	160	12	80	60	200
PSFN 460	1/2 NPT					
PSF 268	3/8 BSP					
PSFN 268	3/8 NPT					
PSF 368	3/8 BSP	185	16	100	80	400
PSFN 368	3/8 NPT					
PSF 468	1/2 BSP					
PSFN 468	1/2 NPT					
PSF 380	3/8 BSP	210	16	120	100	900
PSFN 380	3/8 NPT					
PSF 480	1/2 BSP					
PSFN 480	1/2 NPT					
PSF 4100	1/2 BSP	210	16	120	100	900
PSFN 4100	1/2 NPT					
PSF 5100	3/4 BSP					
PSFN 5100	3/4 NPT					

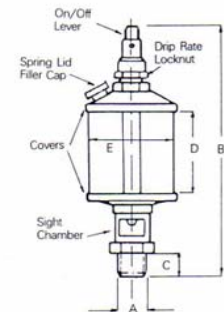

These oilers have shut-off control and needle valve oil feed adjustment. A sight chamber is provided to check the oil flow drip rate

SPARE GLASSES AVAILABLE

To order Plexiglass use Ref PB plus diameter.
To order Glass use Ref GB plus diameter.

i.e. PB 80 Plexiglass bottle 80mm diameter.

Drip Feed Lubricators

Lubrificateurs Goutte à Goutte

Tropföler

Drip Feed Lubricators

Drip Feed Lubricators

Adams

MANUAL ON/OFF SINGLE OUTLET

Material - STEEL Finish - NICKEL Sight Chamber - ALUMINIUM Bottle - PLASTIC
Seals - STENCORRA Maximum operating temperature: 65° C

Product Code	A	B	C	D	E	Capacity ml
USF 7402	1/4" BSP					
USFN 7402	1/4" NPT	111	10	38	32	21
USF 7403	1/4" BSP					
USFN 7403	1/4" NPT	111	11	38	32	21
USF 7409	1/4" BSP					
USFN 7409	1/4" NPT	121	10	48	38	42
USF 7410	1/4" BSP					
USFN 7410	1/4" NPT	121	11	48	38	42
USF 7416	1/8" BSP					
USFN 7416	1/8" NPT	130	10	54	44	70
USF 7417	1/8" BSP					
USFN 7417	1/8" NPT	130	11	54	44	70
USF 7424	1/4" BSP					
USFN 7424	1/4" NPT	144	13	60	51	98
USF 7431	1/2" BSP					
USFN 7431	1/2" NPT	149	13	64	57	140
USF 7432	3/8" BSP					
USFN 7432	3/8" NPT	149	14	64	57	140
USF 7438	1/2" BSP					
USFN 7438	1/2" NPT	156	13	70	64	182
USF 7439	3/8" BSP					
USFN 7439	3/8" NPT	156	14	70	64	182

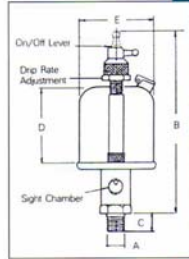

WICK FEED SINGLE OUTLET

Material - STEEL Finish - ZINC Bottle - PLASTIC
Maximum operating temperature 65°C

Product Code	A	B	C	D	E	Capacity ml
SWF 7701	1/8" BSP					
SWFN 7701	1/8" NPT	55	8	37	32	17
SWF 7706	1/8" BSP					
SWFN 7706	1/8" NPT	65	8	47	37	36
SWF 7712	1/8" BSP					
SWFN 7712	1/8" NPT	75	13	53	44	63
SWN 7717	1/4" BSP					
SWFN 7717	1/4" NPT	81	13	59	50	84

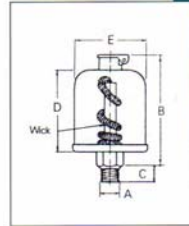

MANUAL ON/OFF SINGLE OUTLET - LARGE FILLER

Material - BRASS Bottle - GLASS, Seals - FIBRE & NITRILE 80
Maximum operating temperature: 80°C Finish - NATURAL BRASS

Product Code	A	B	C	D	E	Capacity ml
GSL 130	1/4" BSP					
GSLN 130	1/4" NPT	88	8	30	30	15
GSL 230	1/4" BSP					
GSLN 230	1/4" NPT	119	12	50	50	80
GSL 250	1/4" BSP					
GSLN 250	1/4" NPT	119	12	50	50	80
GSL 350	3/8" BSP					
GSLN 350	3/8" NPT	129	12	60	60	150
GSL 260	1/2" BSP					
GSLN 260	1/2" NPT	129	12	60	60	150
GSL 360	3/8" BSP					
GSLN 360	3/8" NPT	149	12	80	60	200
GSL 268	1/2" BSP					
GSLN 268	1/2" NPT	149	12	80	60	200
GSL 380	3/8" BSP					
GSLN 380	3/8" NPT	173	16	100	80	400
GSL 480	1/2" BSP					
GSLN 480	1/2" NPT	173	16	100	80	400

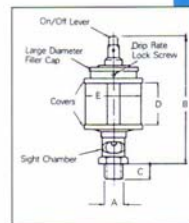

These oilers have shut-off control and needle valve oil feed adjustment. A sight chamber is provided to check the oil flow drip rate

Drip Feed Lubricators

Adams

6

MANUAL ON/OFF SINGLE OUTLET - LARGE FILLER/continued

Material - BRASS Bottle - GLASS

Product Code	A	B	C	D	E	Capacity ml
*GSL 4100	1/4" BSP					
*GSLN 4100	1/4" NPT	208	16	120	100	900
*GSL 5100	3/4" BSP					
*GSLN 5100	3/4" NPT	250	16	150	130	1,900
*GSL 4133	1/2" BSP					
*GSLN 4133	1/2" NPT	250	16	150	130	1,900
*GSL 5133	3/4" BSP					
*GSLN 5133	3/4" NPT	280	16	180	150	3,000
*GSL 4150	1/2" BSP					
*GSLN 4150	1/2" NPT	280	16	180	150	3,000

*Available with low level switch, add suffix "FS" to product code.

Material - BRASS Bottle - PLEXIGLASS

Seals - FIBRE & NITRILE 80
Maximum operating temperature: 70°C
Finish - NATURAL BRASS

Product Code	A	B	C	D	E	Capacity ml
PSL 130	1/4" BSP					
PSLN 130	1/4" NPT	88	8	30	30	15
PSL 230	1/4" BSP					
PSLN 230	1/4" NPT	111	10	40	40	35
PSL 240	1/4" BSP					
PSLN 240	1/4" NPT	119	12	50	50	80
PSL 340	3/8" BSP					
PSLN 340	3/8" NPT	129	12	60	60	150
PSL 250	1/2" BSP					
PSLN 250	1/2" NPT	129	12	60	60	150
PSL 350	3/8" BSP					
PSLN 350	3/8" NPT	149	12	80	60	200
PSL 260	1/2" BSP					
PSLN 260	1/2" NPT	149	12	80	60	200
PSL 360	3/8" BSP					
PSLN 360	3/8" NPT	173	16	100	80	400
PSL 268	1/2" BSP					
PSLN 268	1/2" NPT	173	16	100	80	400
PSL 368	3/8" BSP					
PSLN 368	3/8" NPT	208	16	120	100	900
PSL 380	3/8" BSP					
PSLN 380	3/8" NPT	250	16	150	130	1,900
PSL 480	1/2" BSP					
PSLN 480	1/2" NPT	250	16	150	130	1,900
*PSL 4100	1/4" BSP					
*PSLN 4100	1/4" NPT	208	16	120	100	900
*PSL 5100	3/4" BSP					
*PSLN 5100	3/4" NPT	250	16	150	130	1,900
*PSL 4133	1/2" BSP					
*PSLN 4133	1/2" NPT	250	16	150	130	1,900
*PSL 5133	3/4" BSP					
*PSLN 5133	3/4" NPT	280	16	180	150	3,000
*PSL 4150	1/2" BSP					
*PSLN 4150	1/2" NPT	280	16	180	150	3,000

*Available with low level switch, add suffix "FS" to product code.

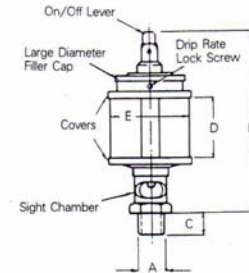

These oilers have shut-off control and needle valve oil feed adjustment. A sight chamber is provided to check the oil flow drip rate

SPARE GLASSES AVAILABLE

To order Plexiglass use Ref PB plus diameter.
To order Glass use Ref GB plus diameter.

i.e. PB 80 Plexiglass bottle 80mm diameter.

Solenoid Operated

Manual ON/OFF

Drip Feed Lubricators

Adams

MANUAL ON/OFF MULTI-OUTLET with 2 outlets/continued

Material - BRASS Bottle - PLEXIGLAS Seals - FIBRE & NITRILE 80 Finish - NICKEL/BRASS
Maximum operating temperature 70°C

Product Code	A	B	C	D	Capacity
		mm	mm	mm	ml
PTM 160	1/8 BSP				
PTMN 160	1/8 NPT	160	60	60	140
PTM 168	1/8 BSP				
PTMN 168	1/8 NPT	180	80	60	200
PTM 180	1/8 BSP				
PTMN 180	1/8 NPT	220	100	80	400
*PTM 1100	1/8 BSP				
*PTMN 1100	1/8 NPT	260	120	100	900
*PTM 1133	1/8 BSP				
*PTMN 1133	1/8 NPT	305	150	133	1900
*PTM 1150	1/8 BSP				
*PTMN 1150	1/8 NPT	335	180	150	3000

* Available with low level switch, add suffix "FS" to product code.
Please state quantity if more than 2 distribution outlets are required.

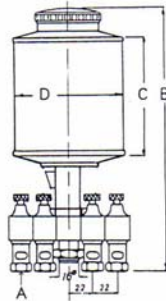

SOLENOID OPERATED MULTI-OUTLET with 2 outlets

Material - BRASS Bottle - GLASS Seals - FIBRE & NITRILE 80 Finish - NICKEL/BRASS
Maximum operating temperature: 80°C

Product Code	A	B	C	D	Capacity
		mm	mm	mm	ml
GET 160	1/8 BSP				
GETN 160	1/8 NPT	175	60	60	140
GET 168	1/8 BSP				
GETN 168	1/8 NPT	195	80	60	200
GET 180	1/8 BSP				
GETN 180	1/8 NPT	235	100	80	400
*GET 1100	1/8 BSP				
*GETN 1100	1/8 NPT	275	120	100	900
*GET 1133	1/8 BSP				
*GETN 1133	1/8 NPT	320	150	133	1900
*GET 1150	1/8 BSP				
*GETN 1150	1/8 NPT	350	180	150	3000

Voltages available: 12V DC, 24V DC, 24V AC, 110V 50Hz, 230V 50Hz, 415V 50Hz
When ordering, please state voltage and number of outlets if more than 2 are required.

* Available with low level switch, add suffix "FS" to product code.

Material - BRASS Bottle - PLEXIGLASS

Seals - FIBRE & NITRILE 80 Maximum operating temperature 70°C
Finish - NICKEL PLATED COVERS

Product Code	A	B	C	D	Capacity
		mm	mm	mm	ml
PET 160	1/8 BSP				
PETN 160	1/8 NPT	175	60	60	140
PET 168	1/8 BSP				
PETN 168	1/8 NPT	195	80	60	200
PET 180	1/8 BSP				
PETN 180	1/8 NPT	235	100	80	400
*PET 1100	1/8 BSP				
*PETN 1100	1/8 NPT	275	120	100	900
*PET 1133	1/8 BSP				
*PETN 1133	1/8 NPT	320	150	133	1900
*PET 1150	1/8 BSP				
*PETN 1150	1/8 NPT	350	180	150	3000

Voltages available: 12V DC, 24V DC, 24V AC, 110V 50Hz, 230V 50Hz, 415V 50Hz

When ordering, please state voltage and number of outlets if more than 2 are required.

* Available with low level switch, add suffix "FS" to product code. Timer for use with GET/PET shown on page 15.

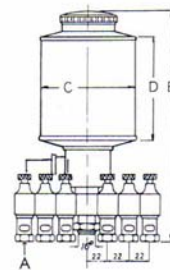

Drip Feed Lubricators

Adams

SOLENOID OPERATED SINGLE OUTLET

Materials: Covers - BRASS Bottle - GLASS Finish - NICKEL
Seals - FIBRE & NITRILE 80 Maximum operating temperature: 80°C
Electrical rating: 12VA IP 20 (DIN 40050)

Product Code	A	F	B	C	D	E	Capacity
			mm	mm	mm	mm	ml
GSD 460	1/2 BSP	1/4 BSP					
GSDN 460	1/2 NPT	1/4 NPT	150	15	60	60	140
GSD 468	1/2 BSP	1/4 BSP					
GSDN 468	1/2 NPT	1/4 NPT	170	15	80	60	200
GSD 480	1/2 BSP	1/4 BSP					
GSDN 480	1/2 NPT	1/4 NPT	200	15	100	80	400
GSD 4100	1/2 BSP	1/4 BSP					
GSDN 4100	1/2 NPT	1/4 NPT	240	15	120	100	900
GSD 4133	1/2 BSP	1/4 BSP					
GSDN 4133	1/2 NPT	1/4 NPT	285	15	150	133	1900
GSD 4150	1/2 BSP	1/4 BSP					
GSDN 4150	1/2 NPT	1/4 NPT	315	15	180	150	3000

Voltages available: 12V DC, 24V DC, 24V AC, 110V 50Hz, 230V 50Hz, 415V 50Hz
When ordering, please state voltage required.

Materials: Covers - BRASS Bottle - PLEXIGLASS Finish - NICKEL

Seals - FIBRE & NITRILE 80 Maximum operating temperature 70°C
Electrical rating 12VA IP20 (DIN 40050)

Product Code	A	F	B	C	D	E	Capacity
			mm	mm	mm	mm	ml
PSD 460	1/2 BSP	1/4 BSP					
PSDN 460	1/2 NPT	1/4 NPT	150	15	60	60	140
PSD 468	1/2 BSP	1/4 BSP					
PSDN 468	1/2 NPT	1/4 NPT	170	15	80	60	200
PSD 480	1/2 BSP	1/4 BSP					
PSDN 480	1/2 NPT	1/4 NPT	200	15	100	80	400
PSD 4100	1/2 BSP	1/4 BSP					
PSDN 4100	1/2 NPT	1/4 NPT	240	15	120	100	900
PSD 4133	1/2 BSP	1/4 BSP					
PSDN 4133	1/2 NPT	1/4 NPT	285	15	150	133	1900
PSD 4150	1/2 BSP	1/4 BSP					
PSDN 4150	1/2 NPT	1/4 NPT	315	15	180	150	3000

Voltages available: 12V DC, 24V DC, 24V AC, 110V 50Hz, 230V 50Hz, 415V 50Hz

When ordering, please state voltage required. Timer for use with GSD/PSD shown on page 15

The multiple drip feed lubricator models GTM, PTM, GET and PET are available with a range of 2 to 24 distribution outlets. This permits the make up of simple and cost effective centralized lubrication systems.

MANUAL ON/OFF MULTI-OUTLET with 2 outlets

Material - BRASS Bottle - GLASS Finish - NICKEL/BRASS
Seals - FIBRE & NITRILE 80 Maximum operating temperature: 80°C

Product Code	A	B	C	D	Capacity
		mm	mm	mm	ml
GTM 160	1/8 BSP				
GTMN 160	1/8 NPT	160	60	60	140
GTM 168	1/8 BSP				
GTMN 168	1/8 NPT	180	80	60	200
GTM 180	1/8 BSP				
GTMN 180	1/8 NPT	220	100	80	400
*GTM 1100	1/8 BSP				
*GTMN 1100	1/8 NPT	260	120	100	900
*GTM 1133	1/8 BSP				
*GTMN 1133	1/8 NPT	305	150	133	1900
*GTM 1150	1/8 BSP				
*GTMN 1150	1/8 NPT	335	180	150	3000

* Available with low level switch, add suffix "FS" to product code.

When ordering, please state quantity if more than 2 distribution outlets are required.

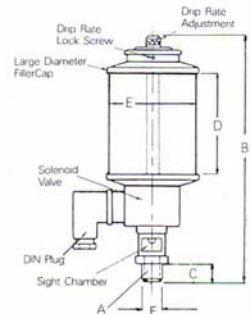

OIL RESERVOIRS

Drip Feed Lubricators

Adams

OIL RESERVOIR with surge arrester

Material - STEEL Bottle - PLASTIC Finish - ZINC
Maximum operating temperature 65°C

Product Code	A	B	C	D	E	Capacity ml
OR 7708	1/4 BSP					
ORN 7708	1/4 NPT	62	12	45	38	35
OR 7714	1/4 BSP					
ORN 7714	1/4 NPT	74	13	54	44	63
OR 7724	1/4 BSP					
ORN 7724	1/4 NPT	86	13	63	57	127
OR 7730	1/4 BSP					
ORN 7730	1/4 NPT	93	13	69	64	170

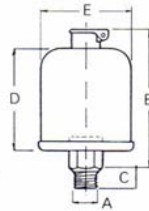

OIL RESERVOIR

Material - BRASS Bottle - GLASS Finish - NICKEL
Seals - FIBRE & NITRILE 80 Maximum operating temperature: 80°C

Product Code	A	B	C	D	E	F	Capacity ml
GRE 260	1/4 BSP						
GREN 260	1/4 NPT						
GRE 360	3/8 BSP	1/8 BSP					
GREN 360	3/8 NPT	1/8 NPT					
GRE 268	1/4 BSP						
GREN 268	1/4 NPT		119	14	80	60	200
GRE 368	3/8 BSP	1/8 BSP					
GREN 368	3/8 NPT	1/8 NPT					
GRE 280	1/4 BSP						
GREN 280	1/4 NPT		148	14	100	80	400
GRE 380	3/8 BSP	1/8 BSP					
GREN 380	3/8 NPT	1/8 NPT					
*GRE 2100	1/4 BSP						
*GREN 2100	1/4 NPT						
*GRE 3100	3/8 BSP	1/8 BSP	189	14	120	100	900
*GREN 3100	3/8 NPT	1/8 NPT					
*GRE 4100	1/2 BSP	1/4 BSP					
*GREN 4100	1/2 NPT	1/4 NPT					
*GRE 2133	1/4 BSP						
*GREN 2133	1/4 NPT						
*GRE 3133	3/8 BSP	1/8 BSP	225	14	150	133	1900
*GREN 3133	3/8 NPT	1/8 NPT					
*GRE 4133	1/2 BSP	1/4 BSP					
*GREN 4133	1/2 NPT	1/4 NPT					
*GRE 2150	1/4 BSP						
*GREN 2150	1/4 NPT						
*GRE 3150	3/8 BSP	1/8 BSP	260	14	180	150	3000
*GREN 3150	3/8 NPT	1/8 NPT					
*GRE 4150	1/2 BSP	1/4 BSP					
*GREN 4150	1/2 NPT	1/4 NPT					

* Available with low level switch. If required, add suffix "FS" to product code.

Material - BRASS Bottle - PLEXIGLASS Finish - NICKEL
Seals - FIBRE & NITRILE 80 Maximum operating temperature: 70°C

Product Code	A	B	C	D	E	F	Capacity ml
PRE 260	1/4 BSP						
PREN 260	1/4 NPT						
PRE 360	3/8 BSP	1/8 BSP					
PREN 360	3/8 NPT	1/8 NPT					
PRE 268	1/4 BSP						
PREN 268	1/4 NPT		119	14	80	60	200
PRE 368	3/8 BSP	1/8 BSP					
PREN 368	3/8 NPT	1/8 NPT					

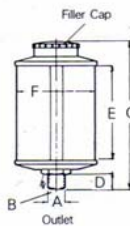

Drip Feed Lubricators

Adams

OIL RESERVOIR/ continued

Material - BRASS Bottle - PLEXIGLASS Finish - NICKEL

Product Code	A	B	C	D	E	F	Capacity ml
PRE 280	1/4 BSP						
PREN 280	1/4 NPT		148	14	100	80	400
PRE 380	3/8 BSP	1/8 BSP					
PREN 380	3/8 NPT	1/8 NPT					
*PRE 2100	1/4 BSP						
*PREN 2100	1/4 NPT						
*PRE 3100	3/8 BSP	1/8 BSP	189	14	120	100	900
*PREN 3100	3/8 NPT	1/8 NPT					
*PRE 4100	1/2 BSP	1/4 BSP					
*PREN 4100	1/2 NPT	1/4 NPT					
*PRE 2133	1/4 BSP						
*PREN 2133	1/4 NPT						
*PRE 3133	3/8 BSP	1/8 BSP	225	14	150	133	1900
*PREN 3133	3/8 NPT	1/8 NPT					
*PRE 4133	1/2 BSP	1/4 BSP					
*PREN 4133	1/2 NPT	1/4 NPT					
*PRE 2150	1/4 BSP						
*PREN 2150	1/4 NPT						
*PRE 3150	3/8 BSP	1/8 BSP	260	14	180	150	3000
*PREN 3150	3/8 NPT	1/8 NPT					
*PRE 4150	1/2 BSP	1/4 BSP					
*PREN 4150	1/2 NPT	1/4 NPT					

* Available with low level switch. If required add suffix "FS" to product code.

OIL RESERVOIRS - MANUAL ON/OFF

Material - BRASS Bottle - GLASS Finish - NICKEL
Seals - FIBRE & NITRILE 80 Maximum operating temperature: 80°C

Product Code	A	B	C	D	E	Capacity ml
GOS 260	1/4 BSP					
GOSN 260	1/4 NPT	150	14	60	60	140
GOS 268	1/4 BSP					
GOSN 268	1/4 NPT	170	14	80	60	200
GOS 280	1/4 BSP					
GOSN 280	1/4 NPT	210	14	100	80	400
*GOS 2100	1/4 BSP					
*GOSN 2100	1/4 NPT	250	14	120	100	900
*GOS 2133	1/4 BSP					
*GOSN 2133	1/4 NPT	295	14	150	133	1900
*GOS 2150	1/4 BSP					
*GOSN 2150	1/4 NPT	325	14	180	150	3000

* Available with low level switch. If required add suffix "FS" to product code.

Material - BRASS Bottle - PLEXIGLASS Finish - NICKEL
Seals - FIBRE & NITRILE 80 Maximum operating temperature: 70°C

Product Code	A	B	C	D	E	Capacity ml
POS 260	1/4 BSP					
POSN 260	1/4 NPT	150	14	60	60	140
POS 268	1/4 BSP					
POSN 268	1/4 NPT	170	14	80	60	200
POS 280	1/4 BSP					
POSN 280	1/4 NPT	210	14	100	80	400
*POS 2100	1/4 BSP					
*POSN 2100	1/4 NPT	250	14	120	100	900
*POS 2133	1/4 BSP					
*POSN 2133	1/4 NPT	295	14	150	133	1900
*POS 2150	1/4 BSP					
*POSN 2150	1/4 NPT	325	14	180	150	3000

* Available with low level switch. If required add suffix "FS" to product code.

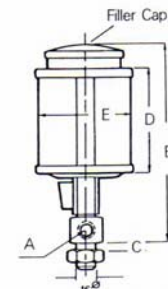
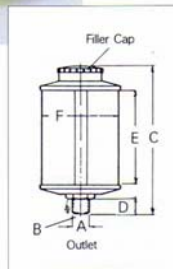

Drip Feed Lubricators

Drip Feed Lubricators

Adams

11

Drip Feed Lubricators

Adams

12

SOLENOID OPERATED - OIL RESERVOIRS

Material - BRASS Bottle - GLASS Finish - NICKEL
 Seals - FIBRE & NITRILE 80
 Maximum operating temperature: 80°C
 Electrical rating: 14VA IP20 (DIN400 50)

Product Code	A	B	C	D	E	Capacity ml
GRS 260	1/4 BSP	150	14	60	60	140
GRSN 260	1/4 NPT					
GRS 268	1/4 BSP	170	14	80	60	200
GRSN 268	1/4 NPT					
GRS 280	1/4 BSP	210	14	100	80	400
GRSN 280	1/4 NPT					
GRS 2100	1/4 BSP	250	14	120	100	900
GRSN 2100	1/4 NPT					
GRS 2133	1/4 BSP	295	14	150	133	1900
GRSN 2133	1/4 NPT					
GRS 2150	1/4 BSP	325	14	180	150	3000
GRSN 2150	1/4 NPT					

The following voltages are available:
 12V DC, 24V DC, 24V AC, 110V 50Hz, 230V 50Hz, 415V 50Hz
 When ordering, please state voltage required.



Material - BRASS Bottle - PLEXIGLASS Finish - NICKEL
 Seals - FIBRE & NITRILE 80
 Maximum operating temperature: 70°C
 Electrical rating: 14VA IP20 (DIN 400 50)

Product Code	A	B	C	D	E	Capacity ml
PRS 260	1/4 BSP	150	14	60	60	140
PRSN 260	1/4 NPT					
PRS 268	1/4 BSP	170	14	80	60	200
PRSN 268	1/4 NPT					
PRS 280	1/4 BSP	210	14	100	80	400
PRSN 280	1/4 NPT					
PRS 2100	1/4 BSP	250	14	120	100	900
PRSN 2100	1/4 NPT					
PRS 2133	1/4 BSP	295	14	150	133	1900
PRSN 2133	1/4 NPT					
PRS 2150	1/4 BSP	325	14	180	150	3000
PRSN 2150	1/4 NPT					

Timer for use with GRS/PRS shown on page number 15

The following voltages are available:
 12V DC, 24V DC, 24V AC, 110V 50Hz, 230V 50Hz, 415V 50Hz
 When ordering, please state voltage required.

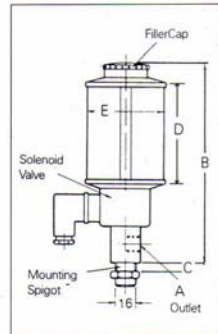

MOUNTING BRACKET - To suit most drip feed lubricators

Product Code	A	B	C	D	E	F	G	I
MW 90	90	80	80	50	25	21	20	3
MW120	120	80	80	50	25	21	20	3

Material - STEEL Finish - ZINC PLATED

STANDARD FIXING THREAD M16x1.5

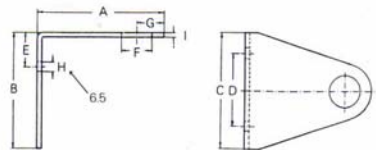

PUMP ONLY

This self priming electromagnetic pump has been designed for intermittently operated single line lubrication systems using light to medium machine and chain oils.
 The electric pump can be controlled by an existing machine control or by our LVT series timer with an adaptor.

Maximum Pressure: 1.5 bar, at approx 10 Mtrs
 Output: 21 cc/min
 Electrical rating: 18.5W IP65
 Maximum temperature: 40°C
 Inlet thread: 1/8" BSP Male
 Outlet thread: 1/8" BSP Female



Material - BRASS - PLASTIC
 Finish - NATURAL BRASS

Product Code	A	B	C	D	E	F	G	H
EPT 200	1/8" BSP	69	58	22	1/4"	10	12	1/8"

The following voltages are available: 24V 50HZ, 42V 50HZ, 48V 50HZ, 110V 50HZ, 220V 50HZ, 220V 60HZ
 When ordering please state voltage required.

The pump EPT is for INTERMITTENT use only.

The following operating instructions should be followed.

CONTINUOUS, INTERMITTENT AND SHORT TIME DUTY:
 (On-time 0.5, sec to max 90, sec).
 Within this range, a continuous signal is ensured provided that the OFF time is equal to the ON time. For example: 60, sec ON and 60, sec OFF.

SHORT TIME DUTY: (On-time 90, sec to max 150, sec).
 Within this range the OFF time must be twice as long as the ON time. For example: 120, sec ON and 240, sec OFF.

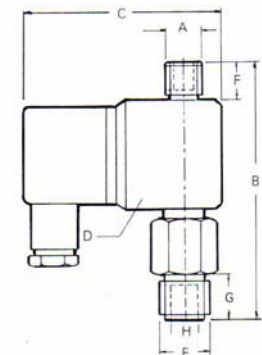

Solenoid Operated

Drip Feed Lubricators

Adams

13

Drip Feed Lubricators

Adams

14

COMBINED PUMP, REGULATOR AND RESERVOIR

Centralized Lubrication Units, Models GPO and PPO, have been designed for intermittently operated single line lubrication systems using light to medium machine and chain oils. The electromagnetic pump can be controlled by an existing machine control or by our LVT series timer with an adaptor.

Maximum Pressure: 1.5 bar, at approx 10 Mtrs
 Output: 21 cc/min
 Electrical rating: 18.5W IP65
 Maximum temperature: 40°C
 Mounting thread M16 supplied with locknut
 Outlet thread: 1/8" BSP Female

Material - BRASS/ALUMINIUM Bottle - GLASS
 Finish - NICKEL PLATED COVERS/NATURAL BRASS

Product Code	A mm	B mm	C mm	D mm	E mm	F mm	Capacity ml
GPO 500	180	100	80				400
GPO 1000	200	120	100	66	22	121	900
GPO 2000	235	150	133				1,900
GPO 3000	300	180	150				3,000

Material - BRASS/ALUMINIUM Bottle - PLEXIGLASS
 Finish - NICKEL PLATED COVERS - NATURAL BRASS

Product Code	A mm	B mm	C mm	D mm	E mm	F mm	Capacity ml
PPO 500	180	100	80				400
PPO 1000	200	120	100	66	22	121	900
PPO 2000	235	150	133				1,900
PPO 3000	300	180	150				3,000

The following voltages are available:
 24V AC, 110V 50HZ, 230V 50HZ, 415V 50HZ
 When ordering please state voltage required.

Available with Low Level switch, add suffix "FS" to product code.

The electromagnetic pumps fitted to GPO and PPO are for INTERMITTENT use only.

The following operating instructions should be followed.

CONTINUOUS, INTERMITTENT AND SHORT TIME DUTY:
 (On-time 0.5, sec to max 90, sec)
 Within this range, a continuous signal is ensured provided that the OFF time is equal to the ON time.
 For example: 60, sec ON and 60, sec OFF.

SHORT TIME DUTY: (On-time 90, sec to max 150, sec).
 Within this range the OFF time must be twice as long as the ON time. For example: 120, sec ON and 240, sec OFF.

SPARE GLASSES AVAILABLE

To order Plexiglass use Ref PB plus diameter.
 To order Glass use Ref GB plus diameter.

i.e. PB 150 Plexiglass bottle 150mm diameter.

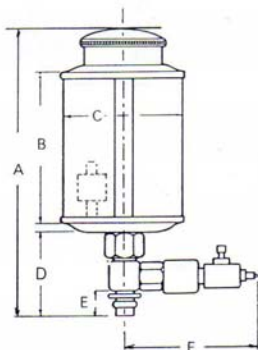

COMBINED PUMP, REGULATOR AND RESERVOIR

Centralized Lubrication Units Model APO has been designed for intermittently operated single line lubrication systems using light to medium machine and chain oils. The electromagnetic pump can be controlled by an existing machine control or by our LVT series timer with an adaptor.

Maximum Pressure: 1.5 bar, at approx 10 Mtrs
 Output: 21 cc/min
 Electrical rating: 18.5W IP65
 Maximum temperature: 40°C
 Mounting thread M16 supplied with locknut
 Outlet thread: 1/8" BSP Female

Material - ALUMINIUM/BRASS/PLASTIC
 Finish - PAINTED GREY - NATURAL BRASS

Product Code	A mm	B mm	C mm	D mm	E mm	F mm	G mm	H mm	Capacity ml
APO 5000	250	165	155	230	325	215	20	40	5,000

Material - STEEL/BRASS/PLASTIC
 Finish - PAINTED GREY - NATURAL BRASS

Product Code	A mm	B mm	C mm	D mm	E mm	F mm	G mm	H mm	Capacity ml
APO 9000	365	185	173	250	345	333	18	41	9,000

The following voltages are available:
 24V 50HZ, 42V 50HZ, 48V 50HZ, 110V 50HZ, 110V 60HZ, 220V 50HZ, 220V 60HZ
 When ordering please state voltage required.

Available with Low Level switch, add suffix "FS" to product code.

The electromagnetic pumps fitted to APO is for INTERMITTENT use only.

The following operating instructions should be followed.

CONTINUOUS, INTERMITTENT AND SHORT TIME DUTY:
 (On-time 0.5, sec to max 90, sec)
 Within this range, a continuous signal is ensured provided that the OFF time is equal to the ON time. For example: 60, sec ON and 60, sec OFF.

SHORT TIME DUTY: (On-time 90, sec to max 150, sec).
 Within this range the OFF time must be twice as long as the ON time. For example: 120, sec ON and 240, sec OFF.

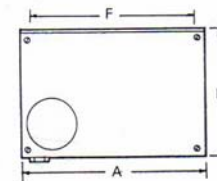
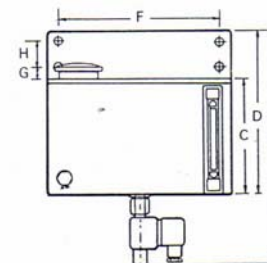

Low Level switch, Timer, Singledrip

LOW LEVEL SWITCH

For monitoring liquid levels in reservoirs of all kinds. For example: Models GSD/PSD, GRS/PRS, GPO/PP0, GTM/PTM, GET/PET, etc. This magnetic switch is equipped with hermetically sealed contacts. The virtually wear-resisting "Reed Switch" is actuated by a magnetic field inside the float. Designed for vertical installation.

Voltage: 300V AC/DC max
Switch current: 0.5A
Contact load: 10W
Temperature range: -20°C to +100°C
Supplied with 1 meter 2 x 0.25mm 2 cable

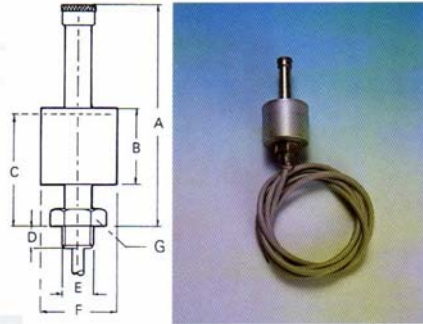

Material - BRASS BODY with ALUMINIUM FLOAT
Finish - NICKEL PLATED

Product Code	A mm	B mm	C mm	D mm	E BSP	F mm	G mm A/F
SMM	65	29	45	8	1/8"	25	14

PROGRAMME TIMER

This programme timer can be fitted to all valves with the cable plug standard to DIN 43 650. Internally programmable via DIP-switches and potentiometers, range 0.5, sec to 10 hours. Four functions can be programmed. Two LEDs display the mains voltage and valve status.



Product Code	Voltage	A mm	B mm	C mm	D mm	E mm
LVT 10780	24/48V 50-60Hz and DC					
		90	70	41.5	21	32
LVT 10781	110/230V 50-60Hz					

Specifications:

Timing range: On: 0.5, sec to 10 hours
Off: 0.5, sec to 10 hours
Switching load: 1 max = 1.5A at 24-48V/50-60Hz and DC
1 max = 0.5A at 110-230V/50-60Hz
Power consumption: 1.0W max
Rating: IP 65
Working temperature: 0°C to +60°C
Outlet: Connector pin standard to DIN 43 650
Material - POLYAMID BODY

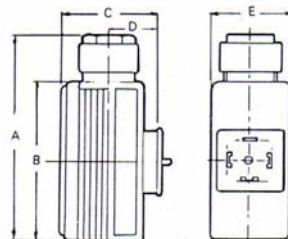

SINGLE DRIP FEED

Material - BRASS, PLEXIGLASS with NATURAL FINISH

Product Code	A mm	B mm	C mm	D mm	-----
LV 10078	4 mm OD TUBE	76	28.6	1/8 BSP	VENTED
LV N10078	1/2" OD TUBE	77	28.6	1/8 NPT	
OS 3471	1/2" OD TUBE	76	28.6	1/8 BSP	UNVENTED
OSN 3471	1/2" OD TUBE	77	28.6	1/8 NPT	
OS 3472	1/4" OD TUBE	76	28.6	1/8 BSP	
OSN 3472	1/4" OD TUBE	77	28.6	1/8 NPT	

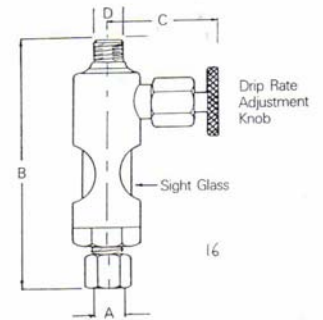

FEMALE OUTLET

Product Code	A mm	B mm	C mm	D mm	E mm	----
ETR 10490	1/8 BSP	70	22	1/8 BSP	38	VENTED
ETRN 10490	1/8 NPT	78	22	1/8 NPT	38	

MALE OUTLET

Product Code	A mm	B mm	C mm	D mm	E mm	----
ETR 10491	1/8 BSP	78	22	1/8 BSP	38	VENTED
ETRN 10491	1/8 NPT	79	22	1/8 NPT	38	

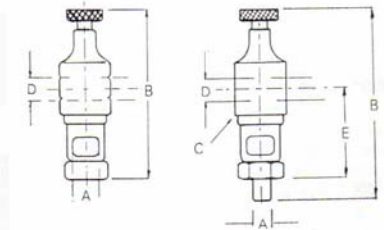

ANGLE BRACKET

for use with ETR/ETRN
Material - BRASS with NATURAL FINISH

Product Code	A mm	B mm	C mm	D mm
ETR 10490/1	6.5	22	30	10

PLUG

Material - BRASS with NATURAL FINISH

Product Code	A mm	B mm	C mm	D mm
ETR 10490/2	1/8 BSP	14	3	8.5
ETRN 10490/2	1/8 NPT	16	3	8.5

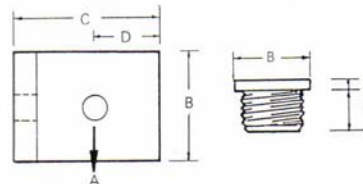

MULTI-DRIP FEED

MULTI-DRIP FEED

Dimensions in mm

Product Code	No of Outlets	A mm	B mm	C mm	D mm	----
LV 10030	4	97	49.6	30.2	81	UNVENTED
LV 10031	6	132	49.6	30.2	116	

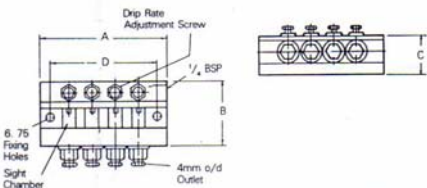

TYPICAL FEED SYSTEM

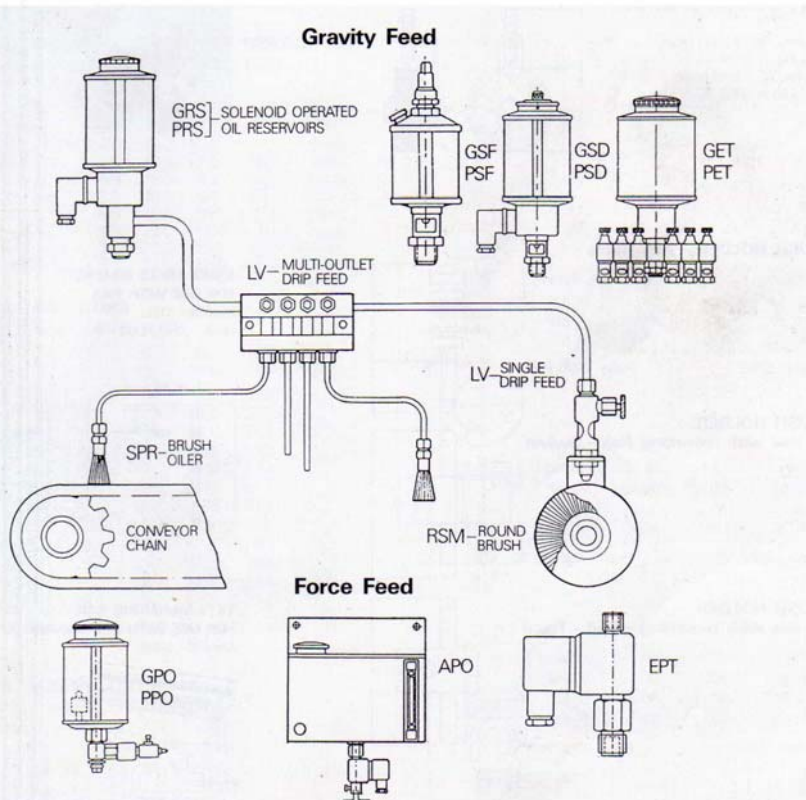

BRUSHES

Dimensions in mm

No	A	B	C	Body
ROUND - 1/8" BSP				
SPR 6.5	6.5	50	65	Brass
SPR 16	16	30	53	Brass
SPR 25	25	45	70	Brass
SPR 30	30	45	70	Brass

FLAT - 1/8" BSP

SPF 57	57	30	50	Aluminium
--------	----	----	----	-----------

Spare brush unit Part No. SPF 57/1

CIRCULAR - 1/8" BSP

RSM 80	80	137	25	Steel Bracket
--------	----	-----	----	---------------

Spare brush unit Part No. RSM 80/1

Add suffix "N" if nylon brush is required ie SPFN 57.
Or suffix "B" if steel brush is required ie SPRB 25

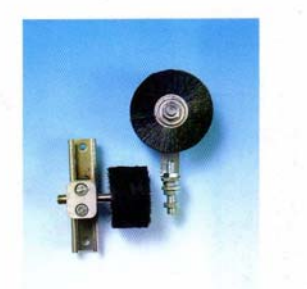
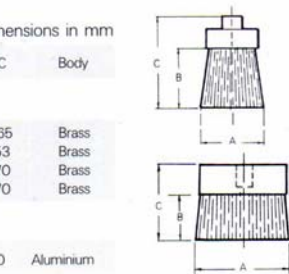

BRUSH HOLDER - Adjustable

No	A	B	Thread
PHA 60	60	47	1/4" BSP
PHA 80	80	47	1/4" BSP
PHA 120	120	47	1/4" BSP

Material - STEEL

Finish - ZINC PLATE

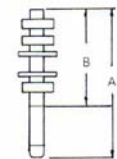

BRUSH HOLDER

For use with mounting Rail - Swivel

No	A	B	Thread
PHB 60	60	30	1/4" BSP
PHB 80	80	30	1/4" BSP
PHB 120	120	30	1/4" BSP

Material - STEEL

Finish - ZINC PLATE

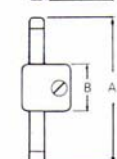

BRUSH HOLDER

For use with mounting - Rail - Fixed

No	A	B	Thread
PHC 60	60	30	1/4" BSP
PHC 80	80	30	1/4" BSP
PHC 120	120	30	1/4" BSP

Material - STEEL

Finish - ZINC PLATE

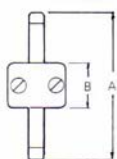

RSMB ANGLE BRACKET FOR USE WITH PHA
Material - STEEL
Finish - ZINC PLATE

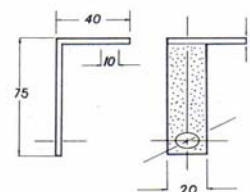

TS11 MOUNTING RAIL FOR USE WITH PHB and PHC
Material - STEEL

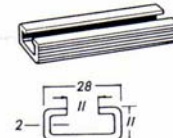

Adams



Spring Greasers and Cups

Two types of spring operated greasers are offered for greasing in areas where it is difficult to access or where constant pressure is required. The plexiglass model has a reservoir capacity of 50 cc and the steel model 80 cc. A range of grease cups is also available.

Graisseurs Automatiques et Graisseurs à Réserve

Deux types de graisseurs automatiques à ressort sont proposés pour le graissage des organes difficiles d'accès ou nécessitant une pression constante. Le modèle en plexiglass a une capacité de 50 cm³, le modèle en acier a une capacité de 80 cm³. Une gamme complète de graisseurs à réserve est également disponible.

Schmierbuchsen & Staufferbuchsen

2 Typen von Federschmierbuchsen gewährleisten Schmierung mit konstantem Fettdruck auch an unzugänglichen Stellen. Der Typ aus Plexiglass hat einen Inhalt von 50 ccm, die Stahlausführung hat 80 ccm. Außerdem steht eine Baureihe sog. "Staufferbuchsen" zur Verfügung.

Spring Greasers

Adams

20

SPRING GREASERS - PLEXIGLASS RESERVOIR

Dimensions	
A	= 1/8", 1/4" or 3/8" BSP
B	= 125mm
C	= 50mm
D	= 55mm

Capacity	= 50cc
Material	= Steel and Brass = Nitrile Rubber Seals = Plexiglass Reservoir

Maximum Working temperature 60°C

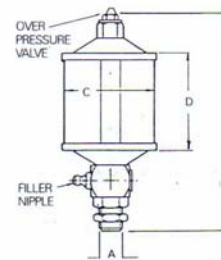

FEATURES

Re-fillable via grease nipple.
Visual level indication

Suitable for use with greases which do not separate under pressure



FIXED FLOW RATE

No	Thread	Capacity
SBK 1501	1/8" BSP	50cc
SBK 2501	1/4" BSP	
SBK 3501	3/8" BSP	

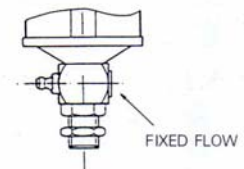

ADJUSTABLE FLOW RATE

No	Thread	Capacity
SBK 1502	1/8" BSP	50cc
SBK 2502	1/4" BSP	
SBK 3502	3/8" BSP	

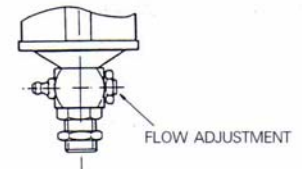

ADJUSTABLE FLOW RATE AND ON/OFF

No	Thread	Capacity
SBK 1503	1/8" BSP	50cc
SBK 2503	1/4" BSP	
SBK 3503	3/8" BSP	

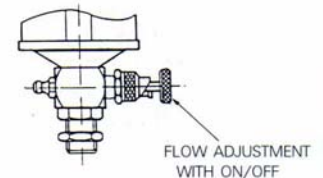

SPRING GREASERS - STEEL RESERVOIR

Dimensions	
A	= 48mm
B	= 135mm
C	= 185mm

Capacity	= 80cc
Material	= Steel Body
	= Fibre Seals
Finish	= Zinc Plated
Operating temperature - 25°C to + 100°C	
Suitable for use with greases which do not separate under pressure	



STANDARD SPRING PRESSURE (RED CAP)

Mounted directly to lubrication point.
Suitable for use with light grease

Product Code	Thread	Capacity	Spring Pressure
SGS 280	1/4" BSP	80cc	4.5 Newtons
SGSN 280	1/4" NPT		

MEDIUM SPRING PRESSURE (BLACK CAP)

Mounted directly to lubrication point.
or up to 30mm of large bore pipe.

Product Code	Thread	Capacity	Spring Pressure
SGS 280/M	1/4" BSP	80cc	6 Newtons
SGSN 280/M	1/4" NPT		

STRONG SPRING PRESSURE (YELLOW CAP)

Suitable for use with large bore pipe up to 50mm

Product Code	Thread	Capacity	Spring Pressure
SGS 280/S	1/4" BSP	80cc	7 Newtons
SGSN 280/S	1/4" NPT		

FEATURES

- Re-fillable via grease nipple.
- Can be mounted in any position.
- Level indicator rod.
- No maintenance required.
- Constant lubrication pressure

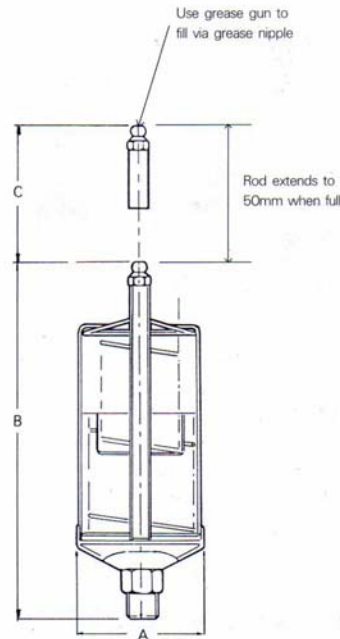

GREASE CUPS - PRESSED STEEL AND BRASS

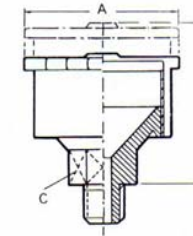

Material BLUE STEEL Material NATURAL BRASS

Product Code	Product Code	Thread	A mm	B mm	C A/F	Capacity
GCR 11	BGCR 11	1/8" BSP	19	35	12mm	4.5 cc
GCR 21	BGCR 21	1/8" BSP	25	38	17mm	7 cc
GCR 22	BGCR 22	1/4" BSP				
GCR 31	BGCR 31	1/8" BSP	34	42	17mm	14 cc
GCR 32	BGCR 32	1/4" BSP				
GCR 41	BGCR 41	1/8" BSP	40	45	17mm	30 cc
GCR 42	BGCR 42	1/4" BSP				
GCR 52	BGCR 52	1/4" BSP	52	52	17mm	53 cc
GCR 62	BGCR 62	1/4" BSP	60	56	17mm	88 cc
GCR 73	BGCR 73	3/8" BSP	70	60	19mm	128 cc
GCR 83	BGCR 83	3/8" BSP	82	68	19mm	200 cc

Constant Level Oilers

Huileurs à Niveau Constant

Ölstandsregler (Constant Level Öler)



Constant Level Oilers

Widely used in the chemical and process industries, constant level oilers maintain a constant fluid level at all times. Available with BSP or NPT thread. Plastic or glass reservoirs with capacities of 85 cc to 500 cc.

Huileurs à Niveau Constant

Largement répandus dans les industries chimiques et de process, les huileurs à niveau constant assurent en permanence un niveau constant de liquide. Fournis en filetage BSP ou NPT, avec réservoirs en verre ou en plastique ils sont disponibles en capacité de 85 cm³ à 500 cm³.

Ölstandsregler (Constant Level Öler)

Diese Öler halten das gewünschte Niveau der Flüssigkeit immer konstant. Eingesetzt werden sie vor allem in der chemischen Industrie und der Verfahrenstechnik. Lieferbar sind diese Öler von 85 ml bis 500ml, mit Behältern aus Glas oder Plexiglas, Anschlussgewinde Rohrgewinde oder NPT.

ALUMINIUM ALLOY BODY - PLASTIC BOTTLE

Product No	A	B	C	D	E	Capacity
ACL 7567	51	82	1/4 BSP	7	51	85 ml
ACL 7568	51	82	1/4 NPT	7	51	85 ml
ACL 7572	57	87	1/4 BSP	7	51	115 ml
ACL 7573	57	87	1/4 NPT	7	51	115 ml
ACL 7577	64	94	1/4 BSP	7	51	158 ml
ACL 7578	64	94	1/4 NPT	7	51	158 ml

Maximum operating temperature 65° C
Finish - ZINC PLATE

STEEL BODY - PLASTIC BOTTLE

Product No	A	B	C	D	E	Capacity
ACL 7563	51	82	1/8 BSP	7	51	85 ml
ACL 7564	51	82	1/8 NPT	7	51	85 ml
ACL 7579	51	82	1/4 BSP	7	51	85 ml
ACL 7580	51	82	1/4 NPT	7	51	85 ml
ACL 7581	57	87	1/4 BSP	7	51	115 ml
ACL 7582	57	87	1/4 NPT	7	51	115 ml
ACL 7583	64	94	1/4 BSP	7	51	158 ml
ACL 7584	64	94	1/4 NPT	7	51	158 ml

Maximum operating temperature 65° C
Finish - ZINC PLATE

ALUMINIUM ALLOY BODY - GLASS BOTTLE

Product No	A	B	C	D	E	Capacity
ACL 7595	61	92	1/4 BSP	7	51	120 ml
ACL 7596	61	92	1/4 NPT	7	51	120 ml

Maximum operating temperature 100° C
Finish - ZINC PLATE

STEEL BODY - GLASS BOTTLE

Product No	A	B	C	D	E	Capacity
ACL 7597	61	92	1/4 BSP	7	51	120 ml
ACL 7598	61	92	1/4 NPT	7	51	120 ml

Maximum operating temperature 100° C
Finish - ZINC PLATE

ACL 7595/2 spare glass 120 ml

BAYONET TYPE - PLASTIC BOTTLE

Product No	A	B	C	D	E	Capacity
ABL 7528	51	93	1/4 BSP	7	51	85 ml
ABL 7538	64	104	1/4 BSP	7	51	158 ml

Maximum operating temperature 65° C
Finish - ZINC PLATE

WIRE GUARD for 120 ml capacity oiler

Product No	A	B	C	D	E
WG 120	60.3	61.9	62.7	6.35	25.4

Material - STEEL

Finish - ZINC PLATE

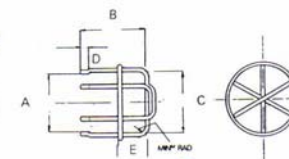
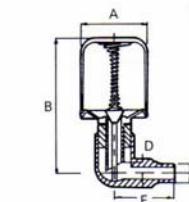
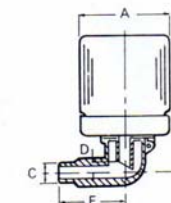
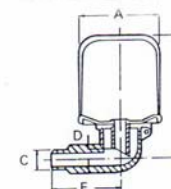

BASE ENTRY - GLASS BOTTLE

Product No	A mm	B Min	B Max	D	E mm	Capacity
VABL 7974	61	132	142	1/4 NPT	26	120 ml
VABL 7983	61	132	142	1/4 BSP	26	120 ml
VABL 7977	64	189	199	1/4 NPT	26	220 ml
VABL 7986	64	189	199	1/4 BSP	26	220 ml
VABL 7980	82	217	227	1/4 NPT	26	500 ml
VABL 7989	82	217	227	1/4 BSP	26	500 ml

Maximum operating temperature - 100° C
Material - STEEL BODY Finish - ZINC PLATE

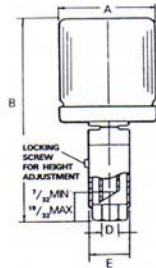

SIDE ENTRY - GLASS BOTTLE

Product No	A mm	B Min	B Max	C mm	D	E mm	Capacity
VABL 7973	61	132	142	33	1/4 NPT	26	120 ml
VABL 7982	61	132	142	33	1/4 BSP	26	120 ml
VABL 7976	64	189	199	33	1/4 NPT	26	220 ml
VABL 7985	64	189	199	33	1/4 BSP	26	220 ml
VABL 7979	82	222	232	33	1/4 NPT	26	500 ml
VABL 7988	82	222	232	33	1/4 BSP	26	500 ml

Maximum operating temperature - 100° C
Material - STEEL BODY Finish - ZINC PLATE

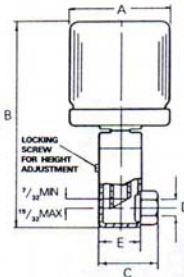

VABL 7976/2 spare glass 220 ml

VABL 7979/1 spare glass 500 ml

SIDE ENTRY - PLASTIC BOTTLE

Product No	A mm	B Min	B Max	C mm	D	Capacity ml
VABL 7970	63.5	135	145	33	1/4 NPT	158

Maximum operating temperature 65° C
Material - STEEL BODY Finish - ZINC PLATE

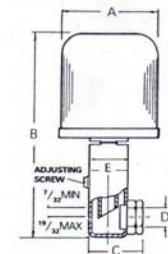

Height adjustment -
Min 1/32 (5.5mm)
Max 19/32 (15mm)

BASE ENTRY - PLASTIC BOTTLE

Product No	A mm	B Min	B Max	D	Capacity ml
VABL 7971	63.5	135	145	1/4 NPT	158

Maximum operating temperature 65° C
Material - STEEL BODY Finish - ZINC PLATE

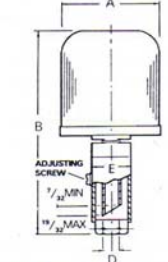

TYPICAL APPLICATION

Constant level oilers, depending on type are mounted into either oil level plug or drain plug holes. The cut-off tube MUST be vertical. Final oil level adjustments can be made by filing the cut-off tube or in the case of the VABL by the adjustment screw. To ensure the correct oil level, the gearbox MUST be filled using the oil feeder tube of the constant level.

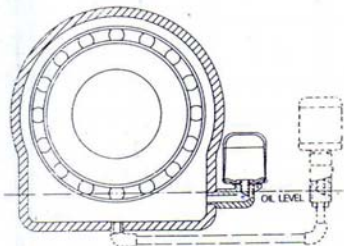

AUTOMATIC OPEN VENT

Product No	A	B	C	D	E
RCL 7780	85	100	60	1/4 BSP	30

Dimension in mm

PORTED VENT

Product No	A	B	C	D	E
RCL 7781	85	100	60	1/4 BSP	30

Dimension in mm

Material - STEEL GLASS Finish - ZINC PLATE

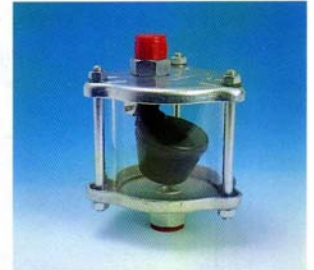
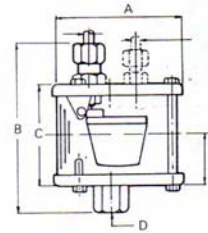

RESERVOIRS

Product No	Capacity	A	B	C	D	E	F	G	H	J	K	Material	Finish
LV 10640	2 litre	155	142	146	50	125	15	20	-	8.5	3/8 BSP	Aluminium	Silver
LV 10641	2.7 litre	155	142	152	50	125	15	20	-	8.5	3/8 BSP	Plastic	Natural
LV 10642	5 litre	248	174	155	75	218	15	20	40	8.5	3/8 BSP	Aluminium	Silver
LV 10644	8 litre	362	190	170	72	242	60	18	41	9	3/8 BSP	Steel	Silver

Dimensions in mm

Add suffix "FS" if low level switch required

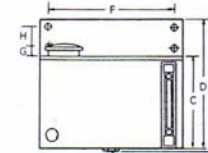
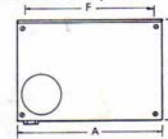

ON/OFF VALVES

MANUALLY OPERATED NICKEL PLATED BRASS BODY

Product No	A	B	C	D	E	F
LV 10521	1/4 BSP	39	38	22	8	21

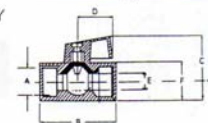

ELECTRIC SOLENOID OPERATED

Product No	Voltage	A	B	C	D	Thread
LV 10523	110.50	82	35	79	32	
LV 10524	240.50	82	35	79	32	1/4 BSP
LV 10525	440.50	82	35	79	32	

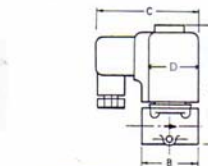

AUTOMATIC CONSTANT LEVEL SYSTEMS

The advantages of having the Adams RCL 7780 constant level oiler incorporates a float operated "shut-off" valve enabling it to be filled from a central reservoir. As the pump loses oil, the pump and the constant level oiler reservoir levels fall. The valve in the RCL opens taking oil from the central reservoir, when the correct oil level is reached, the float closes the valve. The system is gravity fed using the central reservoir as a header tank. Any number of pumps can be incorporated into an automatic constant level system.

MAXIMUM HEAD 2 METRES

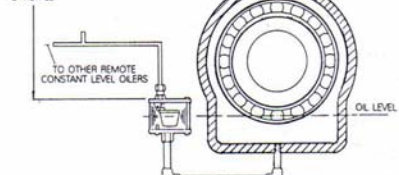

Oil Levels & Windows

Niveaux d'Huile et Voyants

Ölstandsanzeiger & Ölauge

Adams



Oil Levels and Windows

These units are used in industry to visually check the fluid level within a reservoir gearbox. Vertical and angled oil level gauges are available in brass. Screw windows are available in various materials, the "drive-in" type is steel with plastic window.

Niveaux d'Huile et Voyants

Ces accessoires sont utilisés dans l'industrie pour le contrôle visuel du niveau d'un réservoir ou d'un carter. Verticaux ou à l'équerre les niveaux d'huile sont en laiton. Les voyants à visser existent dans différents matériaux, ceux à encastrer sont en acier avec fenêtre en plastique.

Ölstandsanzeiger & Ölauge

Industriell gebräuchliche Geräte für die optische Kontrolle des Flüssigkeitsstandes einem Behälter oder auch Getriebegehäuse. Senkrechte und horizontale Anzeiger sind aus Messing. Ölauge sind in vielen Werkstoffen lieferbar.

Oil Levels and Windows

OIL LEVELS

WITH LOCKNUT (DIN 3018)

Material - BRASS, GLASS Finish - NATURAL
Maximum Working Temperature 90° C

Product Code	A	B mm	C mm	D mm
FGM150	1/8	50	13	27
FGM160	BSP	60	13	27
FGM180		80	13	27
FGM250		50	13	27
FGM260		60	13	27
FGM280		80	13	27
FGM2100	1/4	100	13	27
FGM2125	BSP	125	13	27
FGM2150		150	13	27
FGM2175		175	13	27
FGM2200		200	13	27
FGM2250		250	13	27
FGM2300		300	13	27
FGM350		50	13	34
FGM360		60	13	34
FGM380		80	13	34
FGM3100	3/8	100	13	34
FGM3125	BSP	125	13	34
FGM3150		150	13	34
FGM3175		175	13	34
FGM3200		200	13	34
FGM3250		250	13	34
FGM3300		300	13	34
FGM4100		100	16	38
FGM4125	1/2	125	16	38
FGM4150	BSP	150	16	38
FGM4200		200	16	38
FGM4250		250	16	38

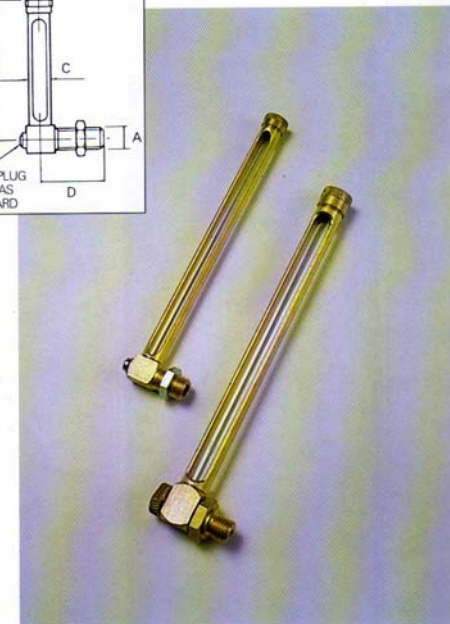
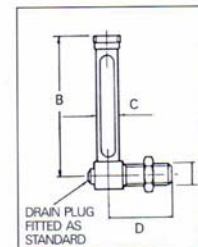

WITH BANJO COUPLING (DIN 3018)

Material - BRASS, GLASS Finish - NATURAL
Maximum Working Temperature 90° C

Product Code	A	B mm	C mm	D mm
FGB160		60	16	28
FGB180	1/8	80	16	28
FGB1100	BSP	100	16	28
FGB1125		125	16	28
FGB250		50	16	30
FGB260		60	16	30
FGB280		80	16	30
FGB2100	1/4	100	16	30
FGB2125	BSP	125	16	30
FGB2150		150	16	30
FGB2175		175	16	30
FGB2200		200	16	30
FGB2250		250	16	30
FGB2300		300	16	30

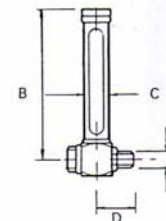

3/8 BSP, 1/2 BSP and NPT sizes available on request

OIL LEVELS

VERTICAL (DIN 3018)

Material - BRASS, GLASS. Finish - NATURAL
Maximum Working Temperature 90°C

Product Code	A	B	C	D
FGV250		50	13	8
FGV260		60	13	8
FGV280		80	13	8
FGV2100		100	13	8
FGV2125	1/2	125	13	8
FGV2150	BSP	150	13	8
FGV2175		175	13	8
FGV2200		200	13	8
FGV2250		250	13	8
FGV2300		300	13	8

1/4, 1/2, 3/4 BSP and NPT sizes available on request

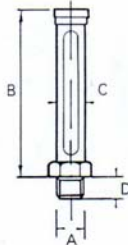

OIL LINE FLOW

Material - BRASS, GLASS, NITRILE. Finish - NATURAL
Maximum Working Pressure 2 bar
Maximum Working Temperature 80°C

Product Code	A	B	C	A/FLATS
OL4279	1/8 BSP	1/8 BSP	70	19
OL4280	1/8 NPT	1/8 NPT	70	19
OL4281	1/4 BSP	1/4 BSP	62	21
OL4282	1/4 NPT	1/4 NPT	62	21
OL4283	3/8 BSP	3/8 BSP	76	31.75
OL4284	3/8 NPT	3/8 NPT	76	31.75
OL4285	1/2 BSP	1/2 BSP	70	32
OL4286	1/2 NPT	1/2 NPT	70	32

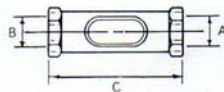

FLANGED

Material - BRASS, GLASS. Finish - NATURAL
Maximum Working Pressure 1 bar
Maximum Working Temperature 100°C

Product Code	A	B	C	D	E	F	G
CW4032	31.8	57.2	46.8	4.8	9.5	17.5	31.8
CW4033	38.1	65.1	54.8	4.8	9.5	17.5	38.1



DRIVE IN

Material - STEEL, PERSPEX. Finish - ZINC PLATE
Maximum Working Pressure 0.7 bar
Maximum Working Temperature 70°C with 0.2 bar pressure

Product Code	Hole Diameter	A	B	C	D
DW4064	22.23 - 22.28	22.30 - 22.35	17.5	7.1	0.4
DW4061	31.75 - 31.80	31.83 - 31.88	25.4	8.7	0.4
DW4062	38.10 - 38.15	38.18 - 38.23	31.8	9.5	0.4
DW4063	50.80 - 50.85	50.88 - 50.93	44.5	10.8	0.4

Add suffix 'A' to part No. if reflector is required.

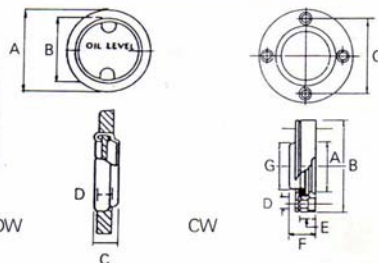

OIL WINDOWS

PLEXIGLASS, ALUMINIUM BODY

Maximum Working Pressure 3.5 bar
Maximum Working Temperature 70°C

Product Code	A	B	C	D	E
AW1145	1/4 BSP	8	13.5	8	17
AW1150	3/8 BSP	8	13.8	11	22
AW1155	1/2 BSP	9	15	15	27
AW1160	3/4 BSP	10	17	20	32
AW1165	1 BSP	14	22.5	25	41
AW1170	1 1/4 BSP	14	22.5	33	50
AW1175	1 1/2 BSP	14	22.5	38	55



HEAT RESISTANT GLASS, ALUMINIUM BODY

Maximum Working Pressure 10 bar
Maximum Working Temperature 130°C

Product Code	A	B	C	D	E
AW1245	1/4 BSP	8	13.5	8	17
AW1250	3/8 BSP	8	13.8	11	22
AW1255	1/2 BSP	9	15	15	27
AW1260	3/4 BSP	10	17	20	32
AW1265	1 BSP	14	22.5	25	41
AW1270	1 1/4 BSP	14	22.5	33	50
AW1275	1 1/2 BSP	14	22.5	38	55
AW1280	2 BSP	14	22.5	46	70
AW1955	M12 x 1.5	7.5	15	8	19
AW1960	M16 x 1.5	8	16	11	24
AW1964	M20 x 1.5	9	17	15	30
AW1972	M24 x 2	9	17	15	30
AW1974	M26 x 1.5	10	18.5	20	35
AW1977	M27 x 1.5	10	18.5	20	35
AW1980	M30 x 1.5	14	24	25	45
AW1983	M33 x 1.5	14	24	25	45
AW1993	M42 x 2	14	24	33	55

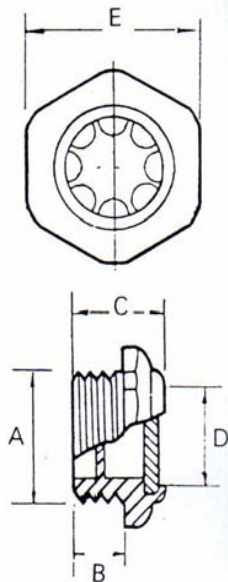

OIL WINDOWS

PLASTIC

Material - PLEXIGLASS
 Maximum Working Pressure 3 bar.
 Maximum Working Temperature 80°C

Product Code	A	B mm	C mm	D mm	E mm
PW4210	1/4 BSP	8.2	13.2	6	17
PW4211	3/8 BSP	9.2	15.7	9	22
PW4212	1/2 BSP	10	18	12	24
PW4213	3/4 BSP	12.2	21.2	16	30
PW4214	1 BSP	11.6	20.6	22	36
PW4215	1 1/4 BSP	12.8	22.3	28	46
PW4216	1 1/2 BSP	13.8	25	33	50
PW4217	2 BSP	13.8	26	43	60
PW4520	M12 x 1	8.2	13.2	6	17
PW4521	M16 x 1.5	9.2	15.7	9	22
PW4522	M20 x 1.5	10.0	18.0	12	24
PW4523	M24 x 1.5	12.2	21.2	16	30
PW4524	M26 x 1.5	12.2	21.2	16	30
PW4525	M27 x 1.5	12.2	21.2	16	30
PW4526	M33 x 1.5	11.6	20.6	22	36
PW4527	M35 x 1.5	11.6	22.5	25	41
PW4528	M42 x 1.5	12.8	22.3	28	46
PW4529	M48 x 1.5	13.8	25.0	33	50
PW4530	M60 x 2	13.8	26.0	43	60

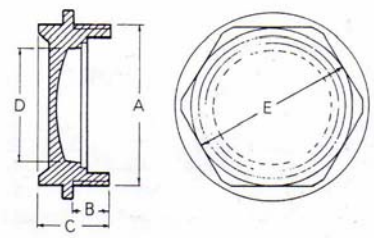

PLASTIC DOMED

Material - POLYCARBONATE
 Maximum Working Pressure 3 bar.
 Maximum Working Temperature 70°C

Product Code	A	B mm	C mm	D mm	E mm
PR4300	1/2 BSP	10	30	14	24
PR4301	3/4 BSP	12	34	20	30
PR4302	1 BSP	12	36	23	36
PR4303	1 1/4 BSP	13	41	28	41
PR4310	M20 x 1.5	10	30	14	24
PR4311	M27 x 1.5	13	34	16	30
PR4312	M33 x 1.5	12	36	22	36
PR4314	M42 x 1.5	13	41	28	41

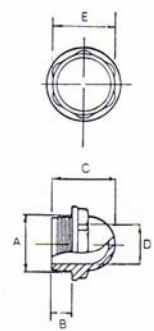

OIL WINDOWS

STEEL

With Toughened Glass Window
 Material - STEEL, GLASS Finish - ZINC PLATE
 Maximum Working Pressure 10 bar.
 Maximum Working Temperature 100°C

Product Code	A	B mm	C mm	D mm	E mm
BWS4042	3/4 BSP	12.7	25.4	19.1	33.0
BWS4052	3/4 NPT	20.6	33.3	19.1	33.0
BWS4043	1 BSP	15.9	33	25.4	42.4
BWS4053	1 NPT	22.2	39.3	25.4	42.4
BWS4044	1 1/4 BSP	15.9	33	31.8	52.1
BWS4054	1 1/4 NPT	22.2	39.3	31.8	52.1
BWS4045	1 1/2 BSP	15.9	33	38.1	61.2
BWS4055	1 1/2 NPT	25.4	42	38.1	61.2
BWS4046	2 BSP	17	34.9	49	69.9

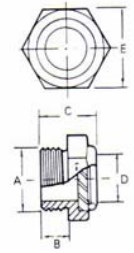

Add suffix 'R' to part no. if reflector is required, eg BWS 4043R

BRASS

With Perspex Window
 Material - BRASS, PERSPEX Finish - NATURAL
 Maximum Working Pressure 7 bar.
 Maximum Working Temperature 70°C

Product Code	A	B mm	C mm	D mm	E mm
BW4040P	3/8 BSP	11.1	17.3	11.1	19.1
BW4041P	1/2 BSP	13.5	23.8	12.7	23.4

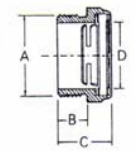

BRASS

With Toughened Glass Window
 Material - BRASS, GLASS Finish - NATURAL
 Maximum Working Pressure 7 bar.
 Maximum Working Temperature 100°C

Product Code	A	B mm	C mm	D mm	E mm
BW4040TG	3/8 BSP	11.1	17.3	11.1	19.1
BW4041TG	1/2 BSP	13.5	23.8	12.7	23.4

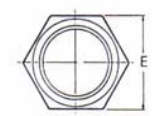

BW4041 available with reflector add suffix 'R'. eg BW4041PR

Adams

Oil Hole
Covers &
Cups

Bouchons
et Coupelles

Klappöler
& Kugelöler



Oil Hole Covers and Cups

A comprehensive range of straight and angled oil hole covers and cups for screw or drive fit mounting. Rotating sleeve and ball spring oilers are also available.

Bouchons et Coupelles

Une large gamme de bouchons droits ou à l'équerre et de coupelles, à visser ou à encastrer. Huileurs à douille tournante ou à clapet sont également disponibles.

Klappöler & Kugelöler

Eine umfassende Serie aller Konstruktionen für alle Arten der Befestigung.

Oil Hole Covers and Cups

BALL VALVE OILERS

Material - STEEL Finish - ZINC PLATE

Product Code	Hole Diameter	A	B mm	C mm
A1401	3/16"	0.190 - 0.192"	4.8	5.6
A1402	1/4"	0.253 - 0.255"	5.6	7.1
A1403	5/16"	0.315 - 0.317"	9.5	8.7
A1404	3/8"	0.378 - 0.380"	8.7	10.3
A1411	5mm	5.1mm	6.0	5.5
A1412	6mm	6.1mm	7.0	6.5
A1413	8mm	8.1mm	9.0	9.0
A1414	10mm	10.1mm	11.0	11.5

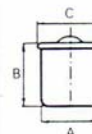

SHOULDER DRIVE OIL CUP

Material - STEEL Finish - NICKEL PLATE

Product Code	Hole Diameter	A	B mm	C mm	D mm	E mm
BS1511	1/4"	0.253 - 0.255"	5.6	11.9	7.2	15.9
BS1512	3/16"	0.190 - 0.192"	5.6	11.9	7.2	15.9
BS1513	6mm	6mm Taper	5.6	11.9	7.2	15.9
BS1514	3/8"	3/8" Taper	5.6	11.9	7.2	15.9
BS1516	5/16"	0.315 - 0.317"	6.4	13.5	8.9	19.1
BS1518	7mm	7mm Taper	6.4	13.5	8.9	19.1
BS1521	3/8"	0.378 - 0.380"	7.1	15.1	10.5	20.6
BS1523	8mm	8mm Taper	7.1	15.1	10.5	20.6
BS1536	10mm	10mm Taper	7.1	18.3	12.7	25.4
BS1549	5/8"	0.628 - 0.630"	9.5	23.8	19.0	34.9
BS1555	3/4"	0.753 - 0.755"	11.1	27.0	25.4	41.3
BS1556	7/8"	0.878 - 0.880"	12.7	28.6	25.4	41.3
BS1560	1"	1.003 - 1.005"	14.3	33.3	31.8	47.6
*BS1573	1 1/8"	1.253 - 1.255"	17.5	38.1	41.3	63.5
*BS1574	1 1/2"	1.503 - 1.507"	17.5	38.1	41.3	63.5

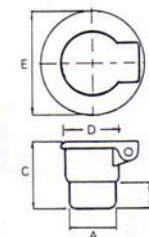

* ADD SUFFIX **DC** IF DUST PROOF COVER IS REQUIRED

DRIVE IN OIL CUPS

Material - STEEL Finish - NICKEL PLATE

Product Code	Hole Diameter	A	B mm	C mm	D mm
B1604	1/4"	0.253 - 0.255"	36.5	41.3	15.9
B1614	1/2"	0.503 - 0.505"	9.5	16.7	25.4
B1620	5/8"	0.628 - 0.630"	10.3	19.1	31.8
B1623	3/8"	0.753 - 0.755"	13.5	23.8	34.9
B1625	1 1/4"	1.003 - 1.005"	14.3	25.4	41.3
B1628	1 1/2"	1.253 - 1.256"	15.9	27.0	47.6
*B1640	1 3/4"	1.753 - 1.757"	14.3	25.4	69.9
*B1650	2 1/4"	2.253 - 2.258"	20.6	31.8	79.4

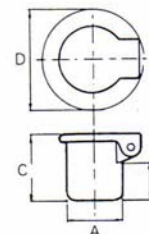

* ADD SUFFIX **DC** IF DUST PROOF COVER IS REQUIRED

SCREW CAP OIL HOLE COVER

Material - BODY BRASS CAP ALUMINUM Finish - NATURAL ANODIZE

Product Code	Hole Diameter	A	B mm	C mm	D mm
AH2181	3/4"	0.752 - 0.754"	6.4	9.5	23.8
AH2182	1 5/16"	1.315 - 1.317"	9.5	17.5	38.1
AH2183	1 5/8"	1.627 - 1.629"	11.9	19.0	49.2

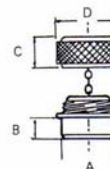

Oil Hole Covers and Cups

Adams

35

Oil Hole Covers & Cups

Adams

36

THREADED OIL CUPS

Material - Body - BRASS Filler - STEEL Finish - NICKEL PLATE

Product Code	A	B	C	D	E	Hex A/Flats
C1730	3/16" - 32 TPI	4.8	14.3	6.4	15.9	5/16"
C1732	1/4" - 32 TPI	4.8	14.3	6.4	15.9	5/16"
C1733	1/4" - 26 TPI	5.6	20.6	7.1	15.9	3/8"
C1735	10 - 32 TPI	4.8	14.3	6.4	15.9	5/16"
C1736	2 BA	4.8	14.3	6.4	15.9	5/16"
C1740	1/4" - 20 TPI	5.6	20.6	7.1	15.9	3/8"
C1743	5/16" - 18 TPI	5.6	20.6	7.1	15.9	3/8"
C1748	3/8" - 24 TPI	6.4	17.5	9.5	20.6	7/16"
C1749	7/8" BSP	6.4	17.5	9.5	20.6	7/16"
C1750	1/8" NPT	6.4	17.5	9.5	20.6	7/16"
C1752	7/16" - 24 TPI	7.1	18.3	11.1	23.8	1 1/2"
C1763	1/4" BSP	11.1	26.2	15.9	31.8	1 1/2"
C1764	1/4" NPT	11.1	26.2	15.9	31.8	1 1/2"
C1787	1/8" BSP	38.1	50.8	9.5	23.8	7/16"
C2141	1/8" BSP	9.5	31.8	15.9	31.8	1 1/2"

* ADD SUFFIX **WF** IF SYPHON TUBE & WICK IS REQUIRED

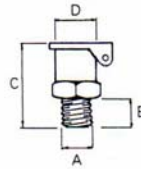

THREADED OIL CUPS ROTATING SPRING LID

Material - Body - BRASS Filler - STEEL Finish - NICKEL PLATE

Product Code	A	B	C	D	E	Hex A/Flats
C1850	M5 x 0.8	4.0	15.0	7.5	16.0	8mm
C1851	M6 x 1	5.0	15.0	7.5	16.0	8mm
C1852	M6 x 1	5.0	18.5	9.5	19.0	10mm
C1853	M8 x 1	5.0	18.5	9.5	19.0	10mm
C1854	M8 x 1.25	6.0	18.5	11.0	21.0	12mm
C1855	M10 x 1.5	6.0	22.0	12.5	22.0	14mm
C1856	M10 x 1	6.0	22.0	12.5	22.0	14mm
C1857	M12 x 1.5	8.0	27.5	15.0	27.0	17mm

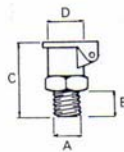

THREADED OIL CUPS

Material - STEEL Finish - NICKEL PLATE

Product Code	A	B	C	D	E	Hex A/Flats
D1914	1/8" BSP	17.5	36.5	15.9	31.8	7/16"
D1920	1/8" BSP	17.5	32.5	19.1	34.9	7/16"
D1921	1/8" NPT	17.5	41.3	19.1	34.9	7/16"
D1927	1/8" BSP	20.6	47.6	25.4	41.3	9/16"
D1928	1/8" BSP	20.6	47.6	25.4	41.3	9/16"
D1937	1/8" BSP	20.6	47.6	31.75	41.3	9/16"
D1938	1/8" BSP	23.8	50.8	31.75	41.3	9/16"
D1952	1/8" BSP	23.8	68.3	41.3	63.5	1 1/2"
D1958	1/8" BSP	28.6	85.7	57.2	79.4	1 1/2"
D1959	3/8" BSP	29.4	85.7	57.2	79.4	1 1/2"
D1960	1/8" BSP	31.8	88.9	57.2	79.4	1 1/2"
D1961	3/8" NPT	28.6	85.7	57.2	79.4	1 1/2"

ADD SUFFIX **WF** IF SYPHON TUBE AND WICK IS REQUIRED

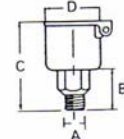

ROTATING SLEEVE OILER

Material - BRASS Finish - NICKEL PLATE

Product Code	A	B	C	D
I2202	1/4" - 26 TPI	6.4	17.5	8.7
I2204	3/4" - 32 TPI	6.4	17.5	8.7
I2209	5/16" - 18 TPI	6.4	19.1	11.1
I2215	1/8" BSP	7.9	22.2	12.7

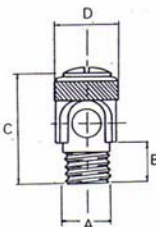

THREADED ELBOW OIL CUP (90°)

Material - Body-BRASS Filler-STEEL Finish-NICKEL PLATE

Product Code	A	B	C	D	E
L2601	3/16" - 32 TPI	19.1	14.3	6.4	8.7
L2602	1/8" - 32 TPI	19.1	14.3	6.4	8.7
L2603	1/4" - 26 TPI	19.1	14.3	6.4	8.7
L2604	10 - 32 TPI	19.1	14.3	6.4	8.7

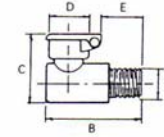

THREADED ELBOW OIL CUP (90°)

Material - Body-BRASS Filler-STEEL Finish-NICKEL PLATE

Product Code	A	B	C	D	E
LS2616	5/16" - 32TPI	23.8	15.9	7.9	10.3
LS2630	1/2" BSP	25.4	20.6	9.5	11.9
LS2633	3/8" - 24TPI	25.4	20.6	9.5	11.9
LS2680	1/8" NPT	34.9	25.4	15.9	14.3
LS2681	1/8" BSP	34.9	25.4	15.9	14.3

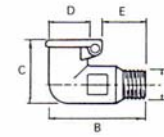

THREADED ELBOW OIL CUP (90°) ROTATING SPRING LID

Material - Body-BRASS Filler-STEEL Finish-NICKEL PLATE

Product Code	A	B	C	D	E
L2710	M6 x 1	24.0	15.0	7.5	13
L2711	M8 x 1	28.0	18.0	9.5	14
L2712	M10 x 1	30.0	20.0	12.5	14
L2713	M12 x 1.5	34.0	22.0	15.0	15

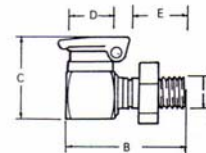

THREADED ELBOW OIL CUP (90°)

Material-STEEL Finish-NICKEL PLATE

Product Code	A	B	C	D	Hex A/Flats
M3011	1/8" BSP	33.3	26.2	15.9	7/16"
M3017	1/8" BSP	36.5	30.2	19.1	7/16"
M3018	1/8" NPT	41.3	28.6	19.1	7/16"
M3024	1/8" BSP	46.0	35.7	25.4	9/16"
M3025	1/8" BSP	46.0	35.7	25.4	9/16"
M3026	1/8" NPT	46.0	34.9	25.4	9/16"
M3031	1/8" BSP	52.4	40.5	31.8	9/16"
M3032	1/8" BSP	52.4	40.5	31.8	9/16"
M3041	1/2" BSP	65.1	52.4	41.3	1 1/2"
M3042	3/8" BSP	65.1	52.4	41.3	1 1/2"
M3064	1/8" BSP	85.7	58.7	57.2	1 1/2"
M3065	3/8" BSP	85.7	58.7	57.2	1 1/2"

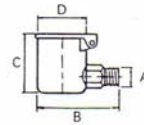

ADD SUFFIX **WF** IF SYPHON TUBE & WICK IS REQUIRED (EXCEPT M3011)

DRIVE IN ELBOW OIL CUP (90°)

Material - Body-BRASS Filler-STEEL Finish-NICKEL PLATE

Product Code	A	B	C	D	E
L2511	0.253 - 0.255"	19.1	14.3	6.4	8.7
L2531	0.378 - 0.380"	27.0	19.8	9.5	11.1

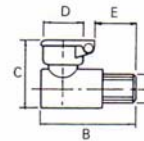

DRIVE IN ELBOW OIL CUP (90°) ROTATING SPRING LID

Material-STEEL Finish-NICKEL PLATE

Product Code	A	B	C	D	E
L2540	6mm	20.0	14.5	7.0	8.5
L2541	8mm	24.0	17.5	9.0	9.0
L2542	10mm	28.0	20.0	11.0	12.0
L2543	12mm	32.0	22.0	13.0	15.0

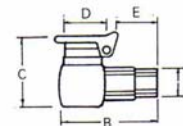

Adams



Grease Nipples

A range of grease nipples in stainless steel or steel, metric or imperial thread hydraulic, button, industrial button or concave heads are available.

Graisseurs

Une gamme de graisseurs en acier ou en inox, filetages métrique ou impérial, hydrauliques, à tête plate ou à cuvette.

Schmiernippel

Lieferbar sind alle Bauformen mit metrischen und Zoll-Gewinden in Stahl und rostfreiem Stahl.

Grease Nipples

STEEL GREASE NIPPLES

Mild steel case hardened head. Zinc plated.
Stress relieved carbon steel spring. Carbon steel ball.

STRAIGHT

Product Code	Thread Type	Thread/Diameter	A mm	B mm	A/F mm	Nominal Hole Size mm
301901	BSF	1/4 x 26	13.7	5.3	5/16	-
303801	BSF	5/16 x 22	15.8	6.4	7/16	-
606901	BSP	1/8 x 28	15.2	5.8	17/16	-
607901	BSP	1/4 x 19	20.3	8.4	7/16	-
201641	UNF	1/8 x 28 (Taper)	13.7	5.1	5/16	-
201680	UNF	1/4 x 28 (9/16 O/L)	23.6	7.1	9/32	-
201698	UNF	1/4 x 28 Taper (1 1/8 O/L)	28.7	7.1	9/32	-
205530	UNF	1/4 x 28 Self Forming	14.2	5.3	5/16	6.0
201711	UNF	5/16 x 24	15.8	6.4	7/16	-
201710	UNF	3/16 x 24	15.8	6.4	7/16	-
201652	UNF	1/4 x 28 (1 1/8 O/L)	17.0	7.1	5/16	-
201610	NPT	1/8 x 27	15.8	6.4	7/16	-
205570	NPT	1/8 - 27 Self Forming	15.2	5.6	7/16	9.5
201627	NPT	1/4 x 18	20.3	8.9	9/16	-
201607	NPT	1/8 x 27 (1 1/4 O/L)	31.8	9.7	7/16	-
608601	Metric	M6 x 1	13.5	4.6	7mm	-
608771	Metric	M6 x 1 Self Forming	14.2	5.5	7mm	5.6
608901	Metric	M8 x 1	15.0	5.8	9mm	-
608971	Metric	M8 x 1 Self Forming	14.5	5.3	9mm	7.6
609201	Metric	M8 x 1.25	15.0	5.8	9mm	-
609301	Metric	M10 x 1	15.2	5.9	11mm	-
609501	Metric	M10 x 1.5	15.2	5.9	11mm	-
			A	B	D	
201728	Drive Fit	3/16	12.7	5.1	5/16	-
201743	Drive Fit	1/4	12.7	5.1	5/16	-
201608	Drive Fit	5/16	14.7	5.3	13/32	-
609601	Drive Fit	M6	14.5	6.0	8mm	-
609801	Drive Fit	M8	15.5	6.1	10mm	-

45° ANGLE

Product Code	Thread Type	Thread/Diameter	A mm	B mm	C mm	A/F
310645	BSF	1/4 x 26	22.4	5.1	8.9	3/8
311945	BSF	5/16 x 22	22.6	5.6	8.9	3/8
616945	BSP	1/8 x 28	23.6	5.6	9.7	7/16
614745	BSP	1/4 x 19	27.4	8.6	9.9	9/16
211637	UNF	1/4 x 28 (Taper)	22.4	5.1	8.9	3/8
211636	UNF	1/4 x 28 (0.3" long)	24.6	7.6	8.9	3/8
211688	NPT	1/8 x 27	24.9	6.9	9.7	7/16
617045	Metric	M6 x 1	22.6	5.6	8.9	9mm
617445	Metric	M8 x 1	22.6	5.6	8.9	9mm
617545	Metric	M8 x 1.25	22.6	5.6	8.9	9mm
619345	Metric	M10 x 1	23.5	5.6	9.7	11mm
617945	Metric	M10 x 1.5	24.9	6.9	9.7	11mm

65° ANGLE

Product Code	Thread Type	Thread/Diameter	A mm	B mm	C mm	A/F
211665	UNF	1/4 x 28 (Taper)	19.3	5.1	10.4	3/8
211612	NPT	1/4 x 27	22.4	6.9	11.7	7/16
211629	NPT	1/4 x 18	24.3	8.6	11.7	9/16

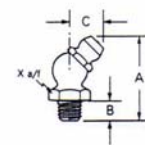
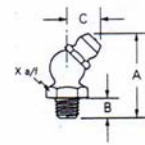
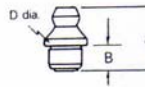
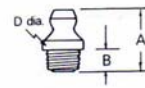
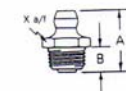

STEEL GREASE NIPPLES

Mild steel case hardened head. Zinc plated.
Stress relieved carbon steel spring. Carbon steel ball

67 1/2° ANGLE

Product Code	Thread Type	Thread	A mm	B mm	C mm	A/F
310667	BSF	1/4 x 26	19.3	5.1	10.4	3/8
311967	BSF	9/16 x 22	19.8	5.6	10.4	3/8
616967	BSP	1/4 x 28	20.3	5.6	11.7	9/16
614767	BSP	1/4 x 19	24.4	8.6	11.7	9/16

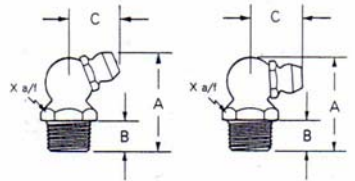

90° ANGLE

Product Code	Thread Type	Thread	A mm	B mm	C mm	A/F
310690	BSF	1/4 x 26	17.5	5.1	10.7	3/8
311990	BSF	9/16 x 22	18.0	5.6	10.7	3/8
616990	BSP	1/4 x 28	19.1	5.6	11.9	9/16
614790	BSP	1/4 x 19	23.4	8.6	11.9	9/16
211911	UNF	1/4 x 28	17.5	5.1	10.7	3/8
211613	NPT	1/4 x 27	20.8	6.9	11.9	9/16
617090	Metric	M6 x 1	18.0	5.6	10.7	9mm
617490	Metric	M8 x 1	18.0	5.6	10.7	9mm
617590	Metric	M8 x 1.25	18.0	5.6	10.7	9mm
619390	Metric	M10 x 1	19.0	5.6	11.9	11mm
617990	Metric	M10 x 1.5	20.0	6.9	11.9	11mm

STANDARD BUTTON HEAD

Product Code	Thread Type	Thread	A mm	B mm	C mm	A/F
320201	BSF	1/4 Two Piece	19.6	5.8	14.3	600°
321101	BSF	3/8 x 20	15.0	6.1	-	600°
324001	BSP	1/4 x 28	15.0	6.1	-	600°
325201	BSP	1/4 x 19	18.8	9.9	-	600°



BUTTON HEAD

Product Code	Thread Type	Thread	A mm	B mm	A/F
TIB-6-2-M	Metric	M6 x 1	-	-	-
TIB-8-2-M	Metric	M8 x 1	-	-	-
TIB-8-3-M	Metric	M8 x 1.25	16	6	15
TIB-10-2-M	Metric	M10 x 1	-	-	-
TIB-10-4-M	Metric	M10 x 1.5	-	-	-
TIB-2-NT	NPT	1/8 NPT	-	-	-

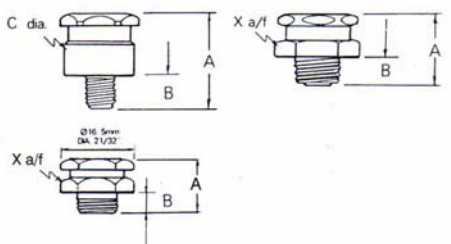

Material - Body, BRASS
Ball & Spring - STAINLESS STEEL

BUTTON HEAD

Product Code	Thread Type	Thread	A mm	B mm	A/F
TIB-2-BP-BR	BSP	1/4 x 28	15	6	15
TIB-4-BP-BR	BSP	1/4 x 19	15	6	15

Material: Body 1.4305 Spring 1.4034. Ball 1.4310

BRITISH STANDARD INDUSTRIAL

Material - Steel
ZINC PLATE

Product Code	Thread Type	Thread	A mm	B mm	A/F
327101	BSP	1/4 x 28	20.3	9.1	.710"
327501	BSP	1/4 x 19	22.6	11.4	.710"
327901	BSP	3/8 x 19	22.6	11.4	.710"

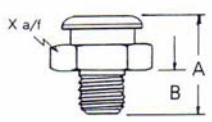

EXTENSIONS

Material - Steel, ZINC PLATE

Product Code	Thread Type	Thread	A mm	B mm	A/F
911531	BSP	1/4 x 28	6.6	19.3	14
911535	BSP	1/4 x 28	6.6	32.0	14

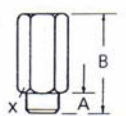

STAINLESS STEEL NIPPLES

STRAIGHT

Product Code	Thread Type	Thread/Diameter	A mm	B mm	D Diameter	A/F
808014	BSP	1/2 x 28	15.2	5.8	-	7/16
808103	BSP	1/2 x 19	20.3	8.4	-	9/16
808025	UNF	1/4 x 28	13.7	5.1	-	9/16
808082	NPT	1/4 x 27	15.8	6.4	-	7/16
808126	NPT	1/4 x 18	20.8	8.9	-	9/16
808036	Metric	M6 x 1	13.7	4.8	-	7mm
808058	Metric	M8 x 1	15.0	5.8	-	9mm
808071	Metric	M10 x 1	15.2	5.8	-	11mm
808028	Drive Fit	3/16	12.7	5.3	8	-
808043	Drive Fit	1/4	12.7	5.3	8	-



45° ANGLE

Product Code	Thread Type	Thread/Diameter	A mm	B mm	C mm	A/F
811445	BSP	1/8 x 28	20.6	5.6	10.4	7/16
812545	UNF	1/4 x 28	22.4	5.1	9.4	3/8
818245	NPT	1/8 x 27	25.2	6.9	10.2	7/16
813645	Metric	M6 x 1	22.6	5.6	8.9	9mm
815845	Metric	M8 x 1	22.4	5.6	8.9	9mm
817145	Metric	M10 x 1	23.1	5.6	10.4	11mm

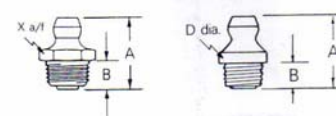

90° ANGLE

Product Code	Thread Type	Thread/Diameter	A mm	B mm	C mm	A/F
811490	BSP	1/4 x 28	19.0	5.6	12.2	7/16
812590	UNF	1/4 x 28	17.5	5.1	11.2	3/8
818290	NPT	1/4 x 27	20.8	6.9	11.9	7/16
813690	Metric	M6 x 1	18.0	5.6	11.2	9mm
815890	Metric	M8 x 1	17.8	5.6	10.7	9mm
817190	Metric	M10 x 1	19.0	5.6	12.1	11mm

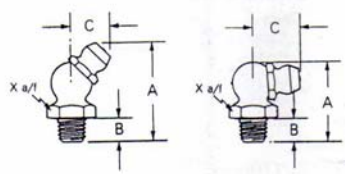

BUTTON HEAD

Product Code	Thread Type	Thread/Diameter	A mm	B mm	A/F
TIB-2-BP-SS	BSP	1/4 x 28	16	6	15
TIB-4-BP-SS	BSP	1/4 x 19	16	6	15



STEEL GREASE NIPPLES

CONCAVE

Product Code	Thread Type	Thread/Diameter	A mm	B mm	A/F
D1-2-BP	BSP	1/8 x 28	9.5	6.5	11
D1-4-BP	BSP	1/4 x 19	14.0	9.5	14
D1-6-2-M	Metric	M6 x 1.0	8.5	5.5	7
D1-8-2-M	Metric	M8 x 1.0	9.5	6.5	7
D1-8-3-M	Metric	M8 x 1.25	9.5	6.5	9
D1-10-2-M	Metric	M10 x 1.0	9.5	6.5	11
DIA-6-M	Drive Fit	6 mm	7.5	5.5	-
DIA-8-M	Drive Fit	8 mm	9.5	6.5	-

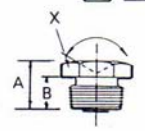
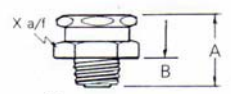

Mild steel case hardened head - Zinc plated - Stress relieved carbon steel spring.

Adams



Grease Fittings & Accessories

Barrettes de Graissage et Accessoires

Schottverschraubungen & Zubehör

Grease Fittings and Accessories

When it is difficult to reach a grease lubrication point, the equipment shown in this section enables it to be reached from outside. When used with the tubes and fittings shown, lubrication by grease gun can be carried out while the machine is operating.

Barrettes de Graissage et Accessoires

Lorsque le point de lubrification est difficile d'accès, les matériels de cette section permettent de le ramener à l'extérieur de la zone. Utilisés avec les tuyauteries et les raccords nécessaires, la lubrification peut être effectuée au pistolet à graisse, même pendant le fonctionnement de la machine.

Schottverschraubungen & Zubehör

Wenn der Schmierpunkt an einer unzugänglichen Stelle liegt, kann er mit Hilfe dieser Einrichtung herausgelegt werden. Mit einer entsprechenden Montageschiene können mehrere Schmierstellen an einem Ort zusammengeführt werden. Röhre und Fittings als Zubehör ermöglichen die Schmierung sogar bei laufender Maschine.

Grease Fittings and Accessories

BULKHEAD FITTING

Supplied complete with compression nut and sleeve.

Product Code	A Diameter	B mm	C mm	D mm	Clear Hole mm
BPA 3/1	3/16"	8	25	13	10
BPA 3/2	3/16"	14	32	13	10
BPA 4/1	1/4" OD	12	32	13	11.5
BPA 4/2	1/4" OD	20	38	13	11.5
BPA 6M/1	6mm OD	12	32	13	11.5
BPA 6M/2	6mm OD	20	38	13	11.5

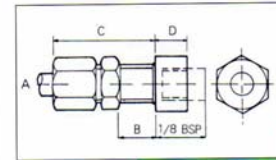

Material - BRASS Finish - NATURAL

COMPRESSION NUT (optional for use with above)

Product Code	A Diameter	B Thread	C mm	D mm	E mm
BPA 3/N	3/16" OD	1/16" BSP	10.5	8	11
BPA 4/N	1/4" OD	11mm x 1	12	8	14
BPA 6M/N	6mm OD	11mm x 1	12	8	14

Material - BRASS Finish - NATURAL

COMPRESSION SLEEVE (optional for use with above)

Product Code	A Diameter	B mm	C mm
BPA 3/S	3/16" ID	6.5	7
BPA 4/S	1/4" ID	6.5	8.5
BPA 6M/S	6mm OD	6.5	8

Material - BRASS Finish - NATURAL

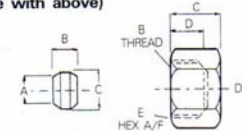

STRAIGHT FITTINGS

Supplied with compression nut and sleeve

Product Code	Tube OD	A Thread	B mm	C mm	D mm	E mm	Suitable Nut	Suitable Sleeve
7061	3/16"	1/8" BSP	16	9.5	11.30	11.30	1001	1021
7063/1	1/4"	1/8" BSP	18.4	9.5	13.30	15.7	1003	1023

Material - BRASS Finish - NATURAL

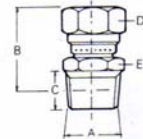

Not supplied with compression nut and sleeve. See opposite sheet for details.

Product Code	Tube OD	A Thread	B Thread	C mm	D mm	E mm	Suitable Nut	Suitable Sleeve
LV 90069	6mm	M6x1	M10x1	22	7	13		
LV 90059	6mm	M8x1	M10x1	21	7	13		
LV 90067	6mm	M8x1.25	M10x1	22	6	13	LV 90460	LV 90560
LV 90060	6mm	M10x1	M10x1	18	6	13		
LV 90068	6mm	M10x1.5	M10x1	20	6	13		
LV 90062	6mm	1/8" BSP	M10x1	18	6	13		

Material - BRASS Finish - NATURAL

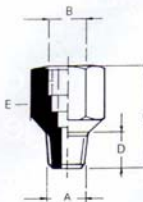

Not for use with compression nut and sleeve.

Product Code	A Thread	B Thread	C mm	D mm	E mm
50-1202-02	1/4" UNF	1/8" BSP	19	6.35	12.7
50-1202-03	3/16" UNF	1/8" BSP	19	8	12.7

Material - STEEL Finish - ZINC PLATED.

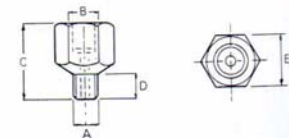

ELBOW FITTINGS - 90 DEGREES

Complete with compression nut and sleeve

Product Code	Tube OD	A Thread	B mm	C mm	D mm	E mm	Suitable Nut	Suitable Sleeve
8021	3/16"	1/8" BSP	22	18.24	9.5	11.30	1001	1021
8023/1	1/4"	1/8" BSP	23.80	18.24	9.5	15.7	1003	1023

Material - BRASS Finish - NATURAL



Not supplied with compression nut and sleeve. See below for details.

Product Code	Tube OD	A Thread	B Thread	C mm	D mm	E mm	Suitable Nut	Suitable Sleeve
LV 90103	6 mm	M8x1	M10x1	17	5.5	14		
LV 90096	6 mm	M8x1	M10x1	17	5.5	14		
LV 90097	6 mm	M8x1.25	M10x1	17	5.5	14	LV 90460	LV 90560
LV 90099	6 mm	M10x1	M10x1	17	5.5	14		
LV 90106	6 mm	M10x1.25	M10x1	17	5.5	14		
LV 90098	6 mm	1/8" BSP	M10x1	17	6.5	14		

Material - BRASS Finish - NATURAL

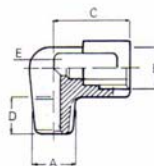

Not for use with compression nuts and sleeve

Product Code	A Thread	B Thread	C mm	D mm	E mm
51-1402-03	1/4" UNF	1/8" BSP	14.20	6.35	14.20
51-1402-02	1/8" UNF	1/8" BSP	14.20	6.35	14.20

Material - STEEL Finish - ZINC PLATED.

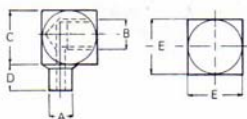

COMPRESSION NUTS AND SLEEVES.

Tube nuts

Product Code	Tube OD	A Thread	B mm	C mm
1001	3/16"	1/8" BSP	10	11.30
1003	1/4"	1/8" BSP	11	15.27
LV 90460	6mm	M10x1	13	10

Material - 1&2 BRASS Finish - NATURAL
3 - STEEL Finish - BLACK ANODISED

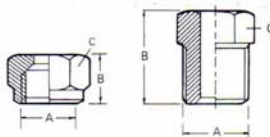

Tube sleeves

Product Code	Tube OD	A mm	B mm
1021	3/16"	5.5	6.2
1023	1/4"	6.35	8
LV 90560	6 mm	6.5	8

Material - BRASS Finish - NATURAL

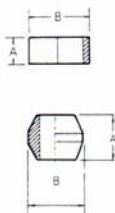

Grease nipples suitable for use with the above are shown within this catalogue

TUBING.

Nylon tube: High pressure. Colour Black

Product Code	Tube OD	Short time burst pressure
135168	3/16"	176 Bar
135169	1/4"	176 Bar
151027	6 mm	176 Bar

Copper tube: Standard duty: Half hard.

Product Code	Tube OD	Maximum Pressure
40 0051 03	3/16"	192 Bar
40 0051 04	1/4"	184 Bar
40 1021 04	6 mm	218 Bar

Double wall brazed steel tube (Bundy).

Product Code	Tube OD	Maximum Pressure
40 0067 03	3/16"	340 Bar
40 0067 04	1/4"	300 Bar
40 1066 04	6 mm	300 Bar



TUBING CLIPS

Single Tube.

Product Code	Tube OD	A mm	B mm
34 0218 03	3/16"	20.3	5.1
34 0218 04	1/4"	21.8	5.1
34 0218 04	6 mm	21.8	5.1

Double Tube.

Product Code	Tube OD	A mm	B mm
34 0219 03	3/16"	27.9	5.1
34 0219 04	1/4"	32.0	5.1
34 0219 04	6 mm	32.0	5.1



Triple Tube.

Product Code	Tube OD	A mm	B mm
34 0220 03	3/16"	32.0	5.1
34 0220 04	1/4"	40.0	5.1
34 0220 04	6 mm	40.0	5.1

Material - STEEL Finish - PLATED

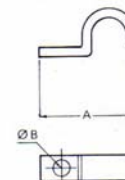



Grease Guns
Oil Cans & Funnels

Pistolets à Graisse,
Burettes et Entonnoirs

Fettpressen, Ölkannen
& Trichter

Grease Guns, Oil Cans and Funnels

A range of grease guns, oil cans, funnels and lubrication pumps suitable for use with the equipment described in this catalogue. Also shown is a range of accessories for use with grease guns.

Pistolets à Graisse, Burettes et Entonnoirs

Une gamme de pistolets graisseurs, de burettes, d'entonnoirs et de pompes de lubrification complète les équipements précédents. Cette section décrit également les accessoires pour pistolets graisseurs.

Fettpressen, Ölkannen & Trichter

Ein breites Angebot an Fettpressen, Ölkannen, Trichtern und Schmierpumpen, geeignet für die vorher gezeigten Einrichtungen, ferner Zubehör für Fettpressen.

Grease Guns, Oil Cans & Funnels

POLYETHYLENE FUNNELS

*Robust Durable Construction
*Chemical and Oil Resistant

02360	Funnel set comprising of 50,75,100&120mm diameter funnels.
02363	100mm diameter. 0.25 litre capacity.
02364	120mm diameter. 0.27 litre capacity.
02365	150mm diameter. 0.70 litre capacity.



*Anti-splash Rim * Removable Brass Filter

02372	160mm diameter. 1.3 litre capacity with integral handle.
02562	160mm diameter. 1.3 litre capacity with integral handle and rigid off set spout.
02566	200mm diameter. 2.9 litre capacity with 300mm detachable flexible spout.
02567	250mm diameter. 3.2 litre capacity with 300mm detachable flexible spout.



POLYETHYLENE LIQUID MEASURES

Integral Dispensing Spout

07361	0.5 litre capacity.
07362	1 litre capacity.
07363	2 litre capacity.
07364	3 litre capacity.
07365	5 litre capacity.



METAL OILERS

With Brass Pump, Rigid and Superflex Discharge Spouts

05223	250ML capacity
05224	350ML capacity
05225	500ML capacity
05226	750ML capacity

*Robust Seamless Drawn Body.
*Open Design Handle Providing Safe and Positive Control

*Durable Paint Finish
*Force Fed Pump with Double Ball Valves.

ONE HAND OPERATED GREASE GUNS

*Easy to Clean Removable Plunger Rod assembly
 *Zinc Die Cast Head with precision machined Cylinder and Steel Piston.
 Specifically designed for use in confined spaces.

- | | |
|-------|--|
| 12250 | 500ccm capacity with Bulk Filling Nipple, Straight rigid delivery tube and 3 Jaw Hydraulic connector |
| 12276 | 125ccm capacity with Bulk Filling Nipple, Straight rigid delivery tube and 3 Jaw Hydraulic connector |

**UNIVERSAL GREASE GUN**

*Zinc Die Head with precision machined Cylinder and Steel Piston.

*Unique Air Venting Ducts.

*Rubber Plunger specifically designed to operate with Cartridge or Bulk Grease

*Exclusive "Posi-Lok" Plunger Rod assembly designed to eliminate problematical air pockets, damaged cartridges or uneven grease flow.

*Easy to clean removable Plunger Rod assembly

- | | |
|----------|---|
| 12733699 | 500ccm capacity with 8mm, high pressure flexible grease hose and 4 jaw hydraulic connector. |
| 12734699 | 500ccm capacity with rigid angled delivery tube and 4 jaw hydraulic connector. |

PUSH TYPE OIL AND GREASE GUN

*Steel Body with Pointed and Universal Connectors.

- | | |
|-------|----------------|
| 12362 | 80ml capacity |
| 12363 | 150ml capacity |
| 12365 | 300ml capacity |

LEVER OPERATED OIL GUN

*Zinc Die Cast Head with precision machined Cylinder and Steel Piston.

- | | |
|-------|---|
| 12602 | 500ml capacity with rigid angled delivery tube and 3 Jaw Hydraulic connector with Ball Check Valve. |
|-------|---|

CONNECTORS

*1/8" BSP Connecting Threads

- | | |
|-------|--|
| 12731 | 4 Jaw hardened with machined Shanks. |
| 12001 | Slide-on Connector to suit Button Head Grease Nipples. |
| 12072 | Universal Connector. |
| 12073 | Pointed Connector. |
| 12074 | Hook-on Connector to suit Button Head Grease Nipples. |
| 12475 | Straight rigid Delivery Tube |
| 12735 | Rigid Angled Delivery Tube. |

**HIGH PRESSURE FLEXIBLE GREASE HOSES**

*400 Bar operating pressure.

*800 Bar maximum pressure.

*900 Bar test pressure.

*Conforming to Din specification.

- | | |
|-------|----------------------|
| 12571 | 11mm x 230mm Rubber. |
| 12755 | 11mm x 300mm Rubber |
| 12765 | 11mm x 500mm Rubber |

- | | |
|-------|---------------------|
| 12753 | 8mm x 230mm Plastic |
| 12756 | 8mm x 300mm Plastic |
| 12766 | 8mm x 500mm Plastic |

**MANUAL LUBRICATING SYSTEM.**

Containing:

Manual Pump Unit,

Dust Cover.

Adjustable stabilising-fixing Bracket,

Follower Plate.

Flexible Rubber Discharge Hose.

Female brass Quick Release Connector.

One hand operated Grease Gun with male brass Quick Release Connector.

Straight rigid Delivery Tube and

Hydraulic Connector.

- | | |
|-------|----------------------------|
| 17615 | To suit 12.5kgm containers |
| 17630 | To suit 25kgm containers |

**DIRECT HIGH PRESSURE LUBRICATING SYSTEM**

Containing:

Manual high pressure Pump Unit,

Metal Dust Cover with integral stabilising fixing mechanism.

Follower Plate.

1.2 metre high pressure Grease Hose.

Rigid angled Delivery Tube and 4 Jaw Hydraulic connector.

- | | |
|-----------|--------------------------|
| 17693 698 | To suit 25kgm containers |
|-----------|--------------------------|



Areas shaded in green are countries where Adams equipment is supplied and in use.



YOUR LOCAL DISTRIBUTOR

STANDARD CONDITIONS

Under these conditions, where not inconsistent with the subject or context, the following expressions shall have the meanings set opposite thereto respectively:-

Company: Adams LubeTech Limited

Purchaser: The person, firm or company whose order is accepted by the company.

Equipment: Refers to the goods or any part thereof (whatever their description) which are the subject of this contract.

No representative or agent of the Company has any authority to vary or add to these Standard Conditions except with the confirmation in writing of a duly authorised officer of the Company. In the event of any conflict or inconsistency between these conditions and the Purchaser's terms or conditions these Conditions shall prevail.

The Purchaser must provide the Company with all the information necessary to enable the Company to proceed with the order. All information must be supplied within a reasonable time, otherwise the Company may at its option cancel the order or charge the Purchaser an additional price for the delay. In case of cancellation the Purchaser will be liable for any loss incurred by it.

(A) Warranty. The Company undertakes, subject to paragraph (B) below, to replace or at its option repair, free of cost, the Equipment or any part or parts thereof supplied by it which shall be proved to the satisfaction of the Company to be defective by reason solely of faulty materials or workmanship supplied or performed by the Company provided that such defect arises within a period of:- Six months from the date when the goods were despatched, at the end of which period all liability of the Company shall cease.

(B) The Company's liability under paragraph (A) is subject to the following conditions:-

- written notice of the defect with full details thereof is received by the Company within seven days of the discovery of the defect;
- the defective Equipment or part or parts thereof is/are returned, satisfactorily packed, at the risk of the Purchaser, carriage paid, to the Company or to such persons as the Company may direct, and in the event of a replacement or part or parts thereof shall become the property of the Company;
- that the defect has not been caused by carelessness, improper treatment or any willful or negligent act or omission or by any omission to comply with any instructions given by the Company or by any use of the Equipment or any parts other than those complying with the Company's specification and obtained from a supplier approved by the Company;
- the Company shall not be liable for the cost, including labour, of removal of a defective part of the Equipment or the like cost of fitting the new part;
- that when the warranty period is expressed merely as a number of months such a period shall be halved if the Equipment is run on a multi-shift basis;
- returned goods will only be accepted on consideration of the individual case, subject to a 15% handling charge. Special goods or standard items with modifications are not returnable.

(C) In the case of parts or components not manufactured by the Company, the Purchaser will only be entitled to the benefit, insofar as it may be transferred to the Purchaser, of any rights which the Company may have against the supplier of such parts or components in respect thereof and the Company's liability in such cases is limited to making the benefit of such rights available to the Purchaser to the extent of the aforesaid.

(A) Subject to clause 4 (C) and except to the extent to which this Paragraph(A) may be held to be void or unenforceable under or by virtue of any provision contained in the Sale of Goods Act 1893 (as amended by the Supply of Goods (implied terms) Act 1973) or any statutory modification or reenactment thereof for the time being in force, the undertaking set out in Clause 4 (A) is in lieu of, and excludes any other conditions or warranties expressed or implied, statutory or otherwise, save for the conditions or warranties implied by Section 12 of the Sale of Goods Act 1893 (as amended) and the company shall not be liable for any loss, injury or damage howsoever caused or arising except to the extent if any to which it may be liable under the undertaking set out in Clause 4(A).

(B) If it should be held in relation to any particular contract that paragraph (A) of this Clause is not effective to exclude altogether any such condition or warranty as is therein mentioned, then:-

- any breach by the Company of any such condition or warranty as may be held to apply in relation to such contract shall not entitle the Purchaser to reject the Equipment, but shall entitle it to damage only;
- the damage recoverable by the Purchaser in respect of any breach by the Company of any such condition or warranty shall be limited to the reasonable cost of remedying the defect or other matter constituting such breach (provided that the Company shall first be afforded the opportunity of itself carrying out the remedial work) and the Company shall not under any circumstances be liable for any other loss or injury or damage suffered by reason of such breach.

In no event shall the Company be liable whether in contract or tort for any loss of use, contracts or of profits or any form of consequential loss howsoever caused or for any personal loss or injury and the Purchaser will indemnify the Company against all liability in respect thereof.

Times or dates for despatch or performance are business estimates only and not contractual obligations of the Company. The Company will make any reasonable endeavour to despatch or perform by the time or date given but will not in any circumstances be liable for loss claimed to have arisen from any delay. Unless specifically guaranteed in writing no dimension, details or statements as to capacity, output or power specified or contained in any drawings, catalogues, shipping specifications or other documents or illustrations are to be treated as contractual. The Company reserves the right to make such changes in specifications as conditions beyond its control may require or will in its judgement be improvements. There is no obligation on the Company to inform the Purchaser that such changes in specification have been made.

The Company shall not be liable for any adaptation of the Company's design to the Purchaser's own circumstances.

Where the Company provides any labour on the Purchaser's site the Purchaser shall indemnify the Company against the consequences of any defect or unsuitability of any tackle or apparatus provided by the Purchaser and against all liabilities for damages, costs and expenses arising out of the death or personal injury to any person or damage to any property howsoever caused provided that this indemnity shall not apply to liabilities arising solely from the negligence of the Company or its employees.

Prices shall be those current at the date of despatch unless otherwise agreed in writing.

Payments shall be made to the Company in accordance with the Company's terms. Cheques or money orders must be made payable to the Company and only the Company's official receipt shall be valid. A receipt shall only be issued if specifically requested by the Purchaser.

The contract price will be payable by the Purchaser in strict accordance with the contract terms notwithstanding any delay in despatch or performance under the contract or any adjustments or corrections of defects which may be required to the Equipment or work. The Company may suspend performance of any contractual obligation to the Purchaser so long as any account of the Purchaser is overdue and any extra costs thereby incurred by the Company shall be reimbursed by the Purchaser. Interest at 2% above the Bank of England minimum lending rate will be charged on all overdue accounts.

The despatch from the Company's premises of any consignments constitutes delivery of the consignment into the Purchaser's possession notwithstanding anything in the tender, order or contract as to place or mode of delivery or payment of carriage. After such despatch the Purchaser as bailee shall take the risk of any loss or injury thereto however caused which may occur before the property in the consignment passes to the Purchaser. The Purchaser shall keep the consignment fully insured and shall indemnify the Company against any such loss or injury.

In no case will the property in the Equipment pass to the Purchaser until payment has been made to the Company of the full contract price for the same including the price for installation or other work (if any) done by the Company.

In case of default by the Purchaser after despatch of the Equipment and before it has become the Purchaser's property of it, before the property in the Equipment has passed to the Purchaser, he commits an act of bankruptcy or, being a Company with limited liability, enters into liquidation or suffers a Receiver to be appointed, the Company may give notice to the Purchaser terminating the contract or the customer's right to possession, as the case may be, whereupon the Purchaser shall, if the Equipment has been despatched, be bound at the Purchaser's own expense to re-deliver the Equipment to the Company. In such cases the Company may (whether with or without previous notice) itself retake possession of the Equipment and the Company is in such circumstances irrevocably authorised by the Purchaser to enter the premises on which the Equipment is situated and to dismantle and remove the same at the Purchaser's expense.

If any inspection or testing prior to despatch is required other than the Company's standard works inspection or tests, or inspection or tests in the presence of the Purchaser's representative, the Company shall carry out such test and inspections or provide the facilities for the same, but such inspections or tests shall be notified at the time of the order and shall be paid for by the Purchaser as an addition to the contract price.

The Company shall not be liable in any way for loss or damage arising from industrial disputes or circumstances beyond the Company's control. If performance of any of the Company's obligations is prevented, delayed or interfered by any such circumstances the Company may suspend performance and if any such circumstance continue for more than 6 months either party may terminate the contract as to the part unperformed at the time of termination but without prejudice to the rights of the parties in respect of that part of the contract which has been performed.

Any dispute between the Purchaser and the Company which cannot be amicably resolved shall be referred to a single arbitrator to be mutually agreed or (failing agreement) to be nominated by the President for the time being of the Confederation of British Industry and the Arbitration (Acts) for the time being in force shall apply.

The contract is governed in all respects by English Law.

If the Company does not receive instructions sufficient to enable the Company to despatch the Equipment within 14 days after the date of notification that it is ready for despatch in accordance with the terms of the Contract, the Purchaser shall forthwith collect the Equipment or arrange for the storage. If the Purchaser shall fail to do this, the Company shall be entitled to arrange storage either at its own works or elsewhere on the Purchaser's behalf and all charges for storage, transport, insurance and demurrage shall be payable by the Purchaser. Payments will be due under the terms of the contract as if the Equipment had been despatched.

PRODUCT CODE CODE PRODUIT ARTIKEL-NUMMER	PAGE No No PAGE SEITE	PRODUCT CODE CODE PRODUIT ARTIKEL-NUMMER	PAGE No No PAGE SEITE	PRODUCT CODE CODE PRODUIT ARTIKEL-NUMMER	PAGE No No PAGE SEITE
02360 to 02372	46	C 1730 to 2141	35	OR 7708 to 7730	9
02562 to 02567	46	C 2141WVF	35	ORN 7708 to 7730	9
05223 to 05226	46	CW 4032 to 4033	29	OS 3471 & 3472	16
07361 to 07365	46	D 1914 to 1961	35	OSN 3471 & 3472	16
1001 to 1023	43	D 1914WVF to 1961WVF	35	PB 30 to 150	13
12001 to 12074	47	D1-2-BP & 4-BP	40	PET 160 to 1150	8
12250 to 12276	47	D1-6-2M to 10-2-M	40	PETN 160 to 1150	8
12362 to 12365	47	D1A-6-M & 8-M	40	PHA 60 to 120	18
12475	47	DW 4061 to 4063	29	PHB 160 to 120	18
12571	48	DW 4061A to 4064A	29	PHC 60 to 120	18
12602	47	EPT 200	12	POS 260 to 2150	10
12731	47	ETR 10490 & 10491	16	POSN 260 to 2150	10
12733.699 & 734.699	47	ETRN 10490 & 10491	16	PPD 500 to 3000	13
12735	47	FGB 160 to 2300	28	PR 4300 to 4314	32
12573 to 12766	48	FGM 150 to 4150	28	PRE 260 to 368	9
135168 & 135169	44	FGV 250 to 2300	29	PRE 280 to 4150	10
151027	44	GB 30 to 150	13	PREN 260 to 368	9
17615 & 17630	48	GCR 11 to 83	22	PREN 280 to 4150	10
17693.698	48	GET 160 to 1150	8	PRS 260 to 2150	11
201607 to 211911	38 & 39	GETN 160 to 1150	8	PRSN 260 to 2150	11
301901 to 327901	38 & 39	GOS 260 to 2150	10	PSD 460 to 4150	7
34 0218 03 & 04	44	GOSN 260 to 2150	10	PSDN 460 to 4150	7
34 0219 03 & 04	44	GPO 500 to 3000	13	PSF 130 to 5100	4
34 0220 03 & 04	44	GRE 260 4150	9	PSFN 130 to 5100	4
40 0061 03 to 04	44	GREN 260 to 4150	9	PSL 130 to 5150	6
40 0067 03 to 04	44	GRS 260 to 2150	11	PSLN 130 to 5150	6
40 1021 04	44	GRSN 260 to 2150	11	PTM 160 to 1150	8
40 1066 04	44	GSD 460 to 4150	7	PTMN 160 to 1150	8
50-1202-02 & 03	42	GSDN 460 to 4150	7	PW 4210 to 4530	31
51-1402-02 & 03	43	GSF 130 to 5100	4	RCL 7780 & 7781	26
606901 to 619390	38 & 39	GSFN 130 to 5100	4	RSM 80	18
7061 to 7063/1	42	GSL 130 to 480	5	SBK 1501 to 1503	20
8021 to 8023/1	43	GSLN 130 to 480	5	SBK 2501 to 2503	20
808014 to 818290	40	GSL 4100 5150	6	SBK 3501 to 3503	20
911531 & 911535	38	GSLN 4100 5150	6	SGS 280	21
A 1401 to 1414	34	GTM 160 to 1150	7	SGS 280M	21
ABL 7528 & 7538	24	GTMN 160 1150	7	SGS 280S	21
ACL 7563 to 7598	24	I 2202 to 2215	35	SGSN 280	21
AH 2181 to 2183	34	L 2511 to 2543	36	SGSN 280M	21
APO 5000 & 9000	14	L 2601 to 2604	36	SGSN 280S	21
AW 4220 to 4267	30	LS 2616 to 2618	36	SMM	15
B 1604 to 1650	34	L 2710 to 2713	36	SPF 57	18
BGCR 11 to 83	22	LV 90059 to LV 90069	42	SPR 6.5 to 30	18
BPA 3/1 to 6M/2	42	LV 90096 to LV 90105	43	SWF 7701 to 7717	5
BPA 3/N to 6M/N	42	LV 90460 & LV 90560	43	T1B-2 & 4-BP-BR	39
BPA 3/S to 6M/6	42	LV 10030 & 10031	17	T1B-2 & 4-BP-SS	40
BS 1511 to 1574	34	LV 10078	16	T1B-2-NT	39
BW 4040 P	32	LV 10521	26	T1B-6-2-M to 10-4-M	39
BW 4040 TG	32	LV 10523 to 10525	26	USF 7402 to 7439	5
BW 4041P & PR	32	LV 10640 to 10644	26	USFN 7402 to 7439	5
BW 4041TG & TGR	32	LVN 10078	16	V&L 7970 to 7989	25
BWS 4042 to 4055	32	LVT 10780 & 10781	15	WG 120	24
BWS 4042R to 4055	32	M 3011 to 3065	36		
		M 3017WVF to 3065	36		
		MW 90 & 120	11		
		OL 4279 to 4286	29		

Drip Feed
Lubricators

Spring Greasers
and Cups

Constant Level
Oilers

Oil Level and
Windows

Oil Hole Covers
and Cups

Grease Nipples

Fittings and
Accessories

Grease Guns,
Oil Cans and
Funnels

Adams LubeTech Limited
Unit 6
Binns Close
Coventry
CV4 9TB

Tel: + 44 (0) 24 7646 7941
Fax: + 44 (0) 24 7669 4002

www.adamslube.com
E-mail: adamslube@dial.pipex.com

